



COMHAIRLE NAN EILEAN SIAR

The Town and Country Planning Scotland Act 1997 – Section 36(1)

Town and Country Planning General Development Procedure Order 2013 Regulation 16

Planning Register - Part 1

Application Details

Reference Number:	24/00254/PPP
Date registered as valid:	10 July 2024
Description of Development:	Erect dwelling with associated access, infrastructure and services
Address or description of location to which the development relates:	40 Eoligarry, Isle of Barra (E:070427 N:807568)
Applicant Name	Mr Malcolm Manford
Applicant Address	14 St Brendan Road, Castlebay, Isle of Barra
Agent name (if applicable)	
Agent address (if applicable)	

The above application summary is accompanied by plans and drawings sufficient to describe the development and where relevant any design statement.

Important Note: on Tuesday 07 November 2023, Comhairle nan Eilean Siar experienced a criminal cyber incident and is working with Police Scotland, the Scottish Government and the National Cyber Security Centre to investigate the matter.

The Online Planning Portal remains unavailable as does our suite of integrated software and hardware systems. In order to enable access by the wider public to application documents and consult upon planning applications, interim systems have been put in place on the temporary website of Comhairle nan Eilean Siar, including a rudimentary facility to display a limited number of documents per application.

Any party wishing to view the application file in full may do so at the offices of Comhairle nan Eilean Siar at Sandwick Road, Stornoway Isle of Lewis, HS1 2BW or Balivanich, Isle of Benbecula. HS7 5LA, ordinarily between 9am and 5pm Monday to Friday (excluding public and local holidays). It is recommended that in advance of visiting an office to view an application that you make an appointment by sending an email to planning@cne-siar.gov.uk

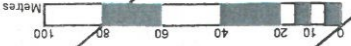
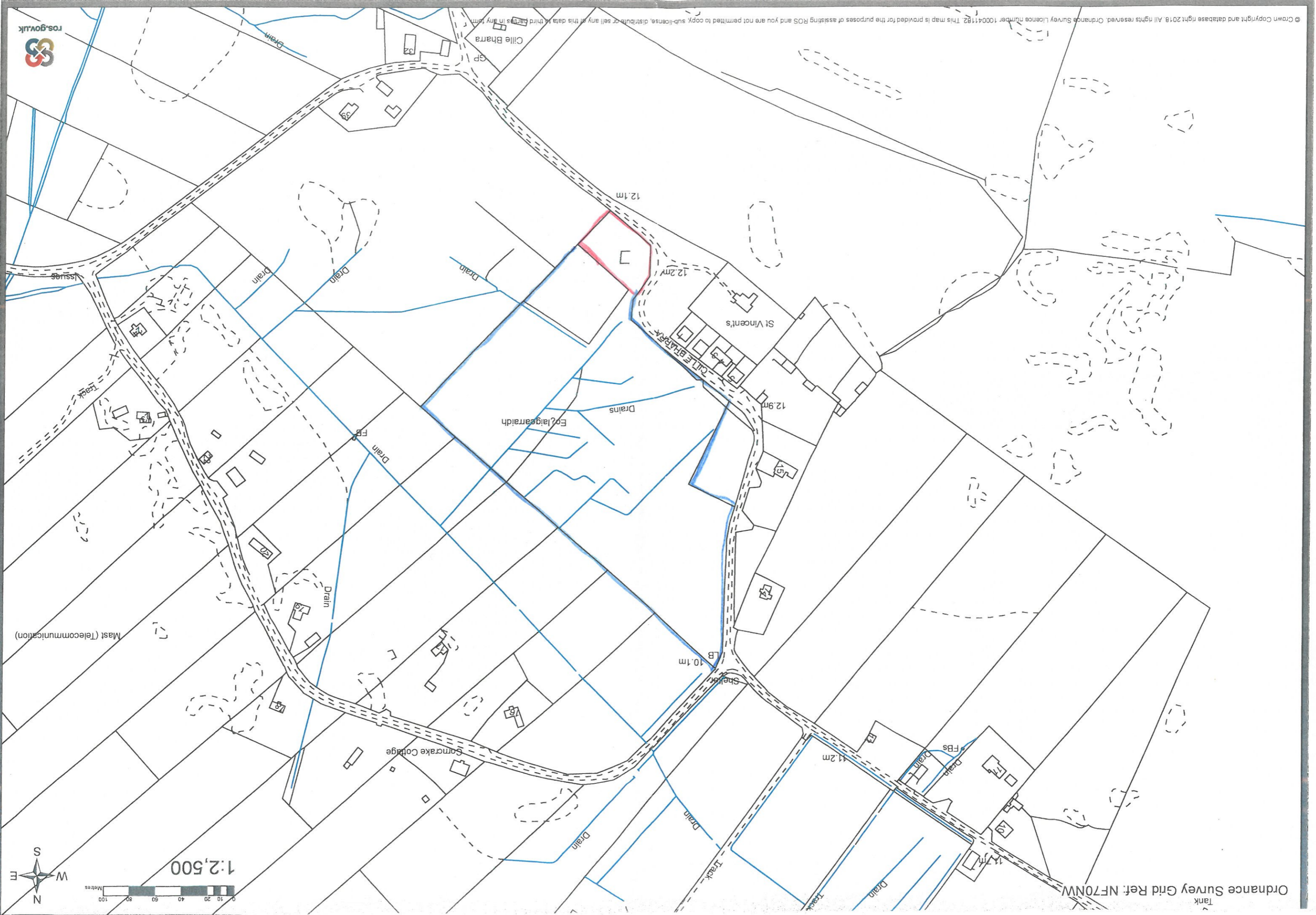

1:2,500

Ordnance Survey Grid Ref: NF70NW

Tank

© Crown Copyright and database right 2018. All rights reserved. Ordnance Survey Licence number 100041182. This map is provided for the purposes of assisting ROS and you are not permitted to copy, sub-license, distribute or sell any of this data to third parties in any form.

LAND BELONGING TO THE SECRETARY
OF STATE FOR SCOTLAND

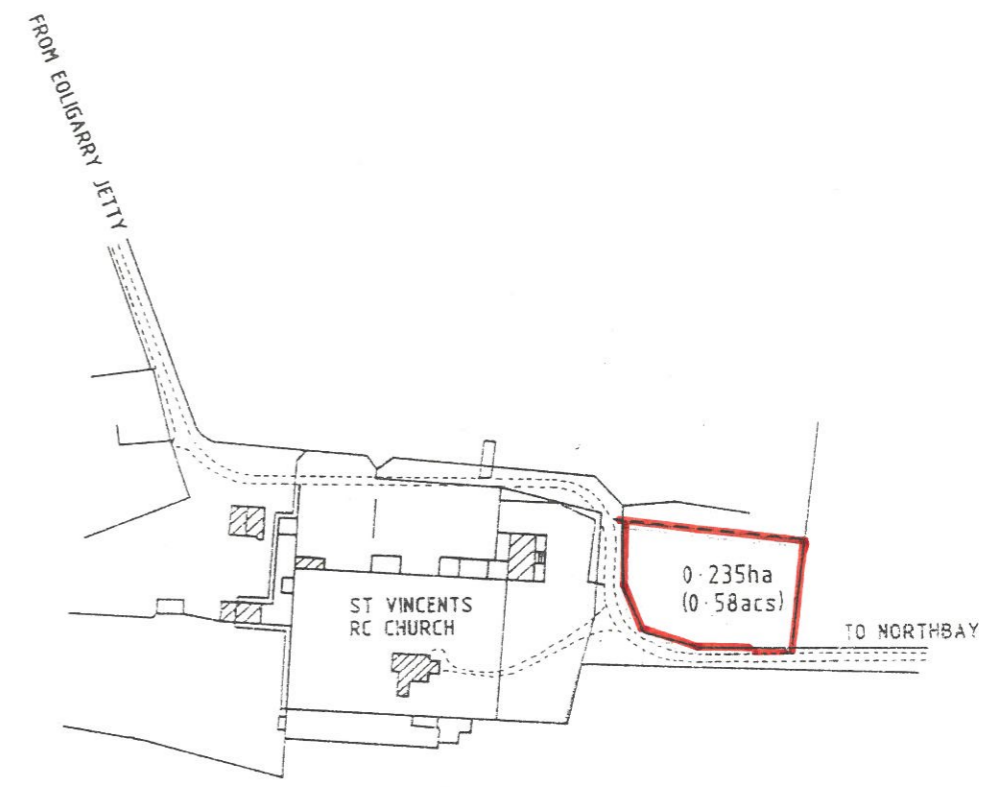
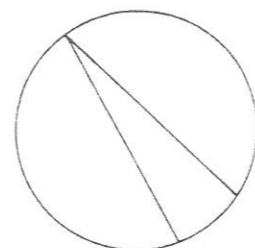

LOCATION PLAN
SCALE 1:2500

SCALE 1:500

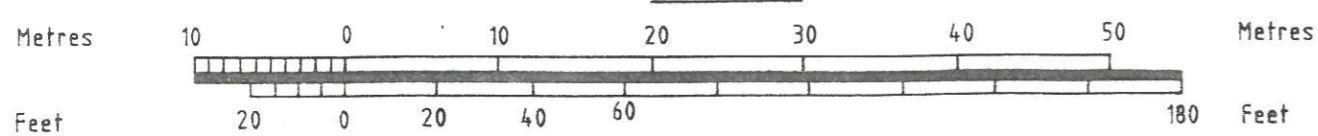

© CROWN COPYRIGHT 1992
BASE MAP PREPARED FROM
THE ORDNANCE SURVEY MAP

Ref. No.	195	A3
Plan No.	299	p300
Drawn	AT/DJB	
Traced	LT	
Date	20.3.92	

EOLIGARRY ESTATE — BARRA
WESTERN ISLES ISLANDS AREA
(INVERNESS — SHIRE)
LAND AT CROFT No. 40 EOLIGARRY

21.92