



# COMHAIRLE NAN EILEAN SIAR

The Town and Country Planning Scotland Act 1997 – Section 36(1)

Town and Country Planning General Development Procedure Order 2013 Regulation 16

Planning Register – Part 1

## Application Details

Reference Number	24/00261/PPD
Date registered as valid	16/07/2024
Description of Development	Create hardstanding for parking and site caravan
Address or description of location to which the development relates	Caravan, 15 Lemreway, Lochs, Isle of Lewis
Co-ordinates	N 911 999, E 137,931
Applicant Name	Ms Ruth Graham
Applicant Address	15 Lemreway, Lochs, Isle of Lewis, HS2 9RD
Agent name (if applicable)	N/A
Agent Address (if applicable)	

**The above application summary is accompanied by plans and drawings sufficient to describe the development and where relevant any design statement.**

Important Note: on Tuesday 07 November 2023, Comhairle nan Eilean Siar experienced a criminal cyber incident and is working with Police Scotland, the Scottish Government and the National Cyber Security Centre to investigate the matter.

The Online Planning Portal remains unavailable as does our suite of integrated software and hardware systems. In order to enable access by the wider public to application documents and consult upon planning applications, interim systems have been put in place on the temporary website of Comhairle nan Eilean Siar, including a rudimentary facility to display a limited number of documents per application.

Any party wishing to view the application file in full may do so at the offices of Comhairle nan Eilean Siar at Sandwick Road, Stornoway Isle of Lewis, HS1 2BW or Balivanich, Isle of Benbecula. HS7 5LA, ordinarily between 9am and 5pm Monday to Friday (excluding public and local holidays). It is recommended that in advance of visiting an office to view an application that you make an appointment by sending an email to [planning@cne-siar.gov.uk](mailto:planning@cne-siar.gov.uk)

# 15 Lemreway, Isle Of Lewis, HS2 9RD

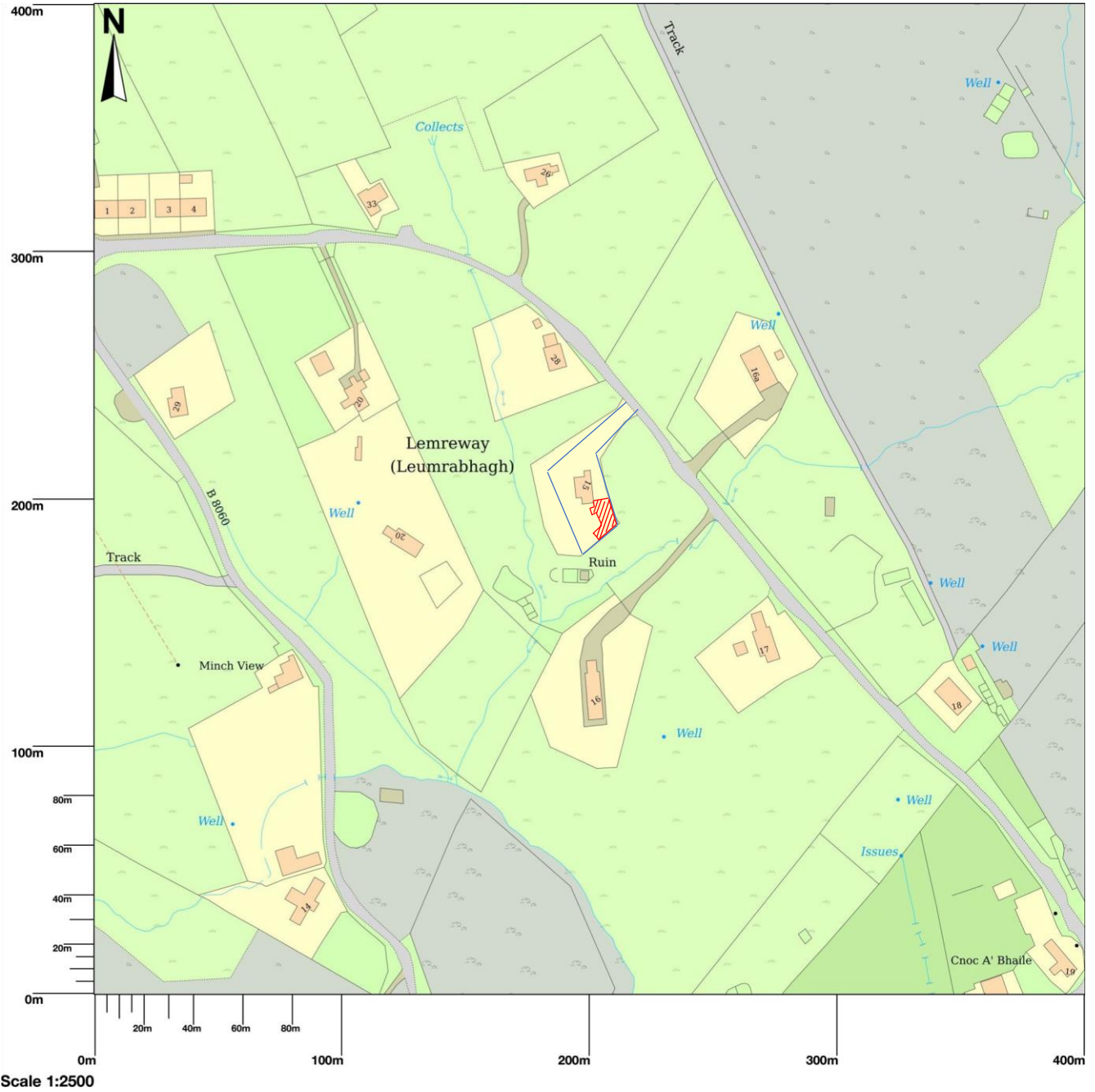

© Crown copyright and database rights 2024 OS 100054135. Map area bounded by: 137721,911817 138121,912217. Produced on 30 June 2024 from the OS National Geographic Database. Supplied by UKPlanningMaps.com. Unique plan reference: p16f/uk/1118427/1504902



# 15 Lemreway, Isle Of Lewis, HS2 9RD

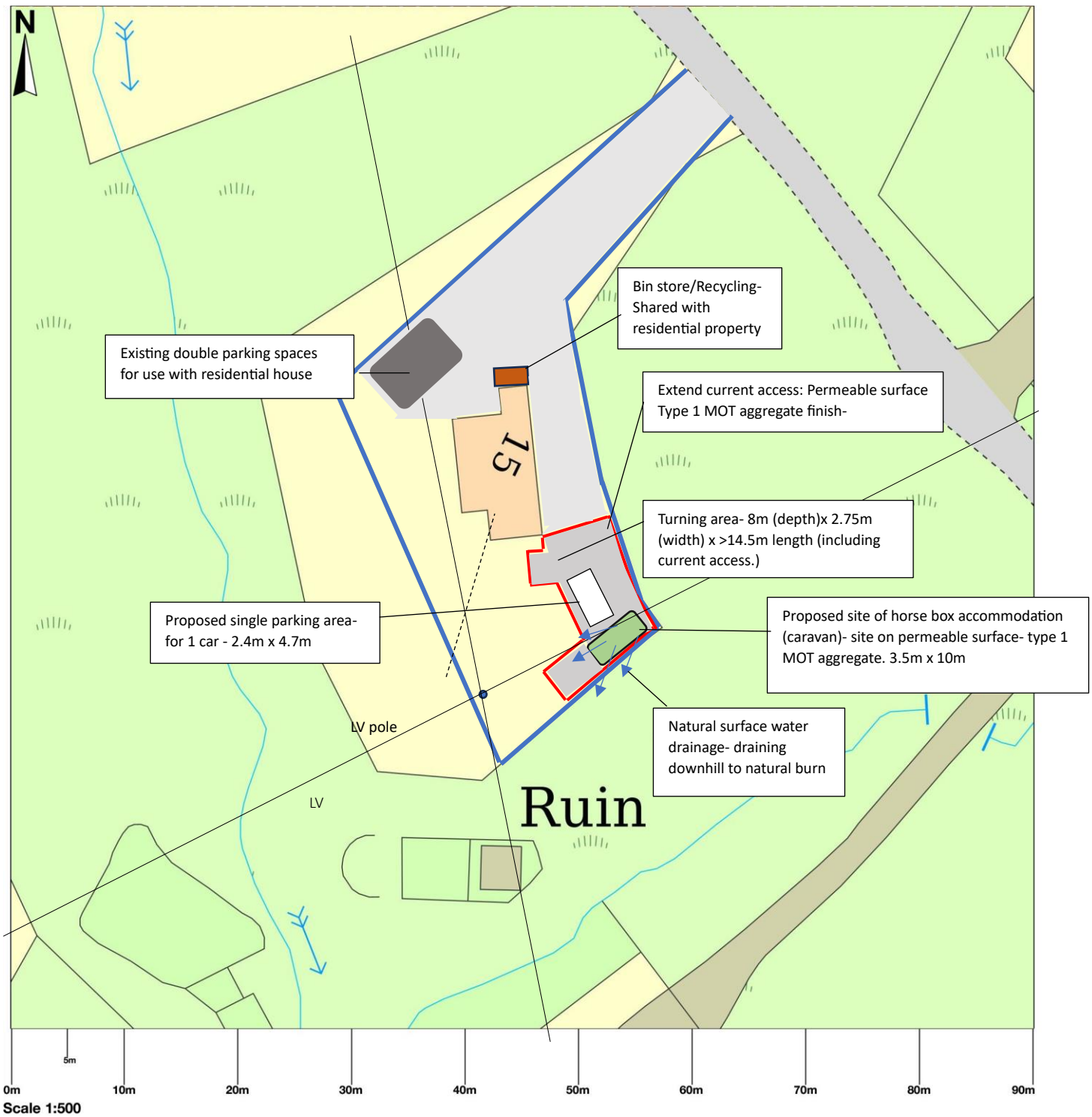

© Crown copyright and database rights 2024 OS 100054135. Map area bounded by: 137876,911972 137966,912062. Produced on 30 June 2024 from the OS National Geographic Database. Supplied by UKPlanningMaps.com. Unique plan reference: b90f/uk/1118427/1504899



Converted horse-box accommodation, external dimensions

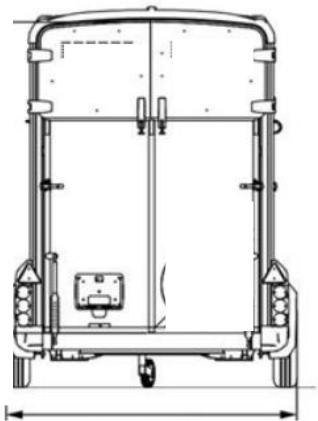
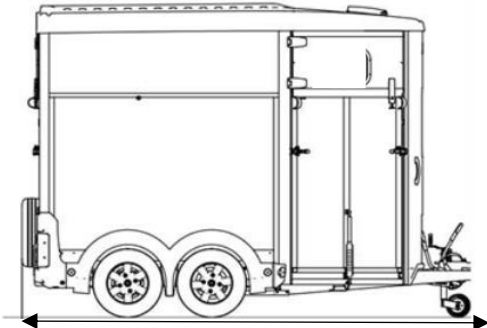
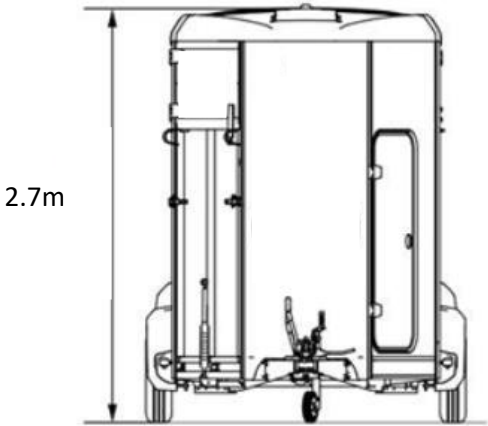

2.24m

Exterior aspects/finishes including windows and doors- photographs.





# Converted Horsebox accommodation- Internal lay out

