



COMHAIRLE NAN EILEAN SIAR

The Town and Country Planning Scotland Act 1997 – Section 36(1)

Town and Country Planning General Development Procedure Order 2013 Regulation 16

Planning Register – Part 1

Application Details

Reference Number	24/00255/PPD
Date registered as valid	09/07/24
Description of Development	Change of use of land to site caravan pod for holiday let
Address or description of location to which the development relates	Pod, 20 Breascleite, Isle of Lewis
Co-ordinates	N 935 545, E 121 742
Applicant Name	Mr Angus MacBain
Applicant Address	20A Breascleite, Isle of Lewis, HS2 9EF
Agent name (if applicable)	Mr David Macleod, Total Design (Lighthill) Ltd
Agent Address (if applicable)	Balard, 68 Lighthill, Back, Isle of Lewis

The above application summary is accompanied by plans and drawings sufficient to describe the development and where relevant any design statement.

Important Note: on Tuesday 07 November 2023, Comhairle nan Eilean Siar experienced a criminal cyber incident and is working with Police Scotland, the Scottish Government and the National Cyber Security Centre to investigate the matter.

The Online Planning Portal remains unavailable as does our suite of integrated software and hardware systems. In order to enable access by the wider public to application documents and consult upon planning applications, interim systems have been put in place on the temporary website of Comhairle nan Eilean Siar, including a rudimentary facility to display a limited number of documents per application.

Any party wishing to view the application file in full may do so at the offices of Comhairle nan Eilean Siar at Sandwick Road, Stornoway Isle of Lewis, HS1 2BW or Balivanich, Isle of Benbecula. HS7 5LA, ordinarily between 9am and 5pm Monday to Friday (excluding public and local holidays). It is recommended that in advance of visiting an office to view an application that you make an appointment by sending an email to planning@cne-siar.gov.uk

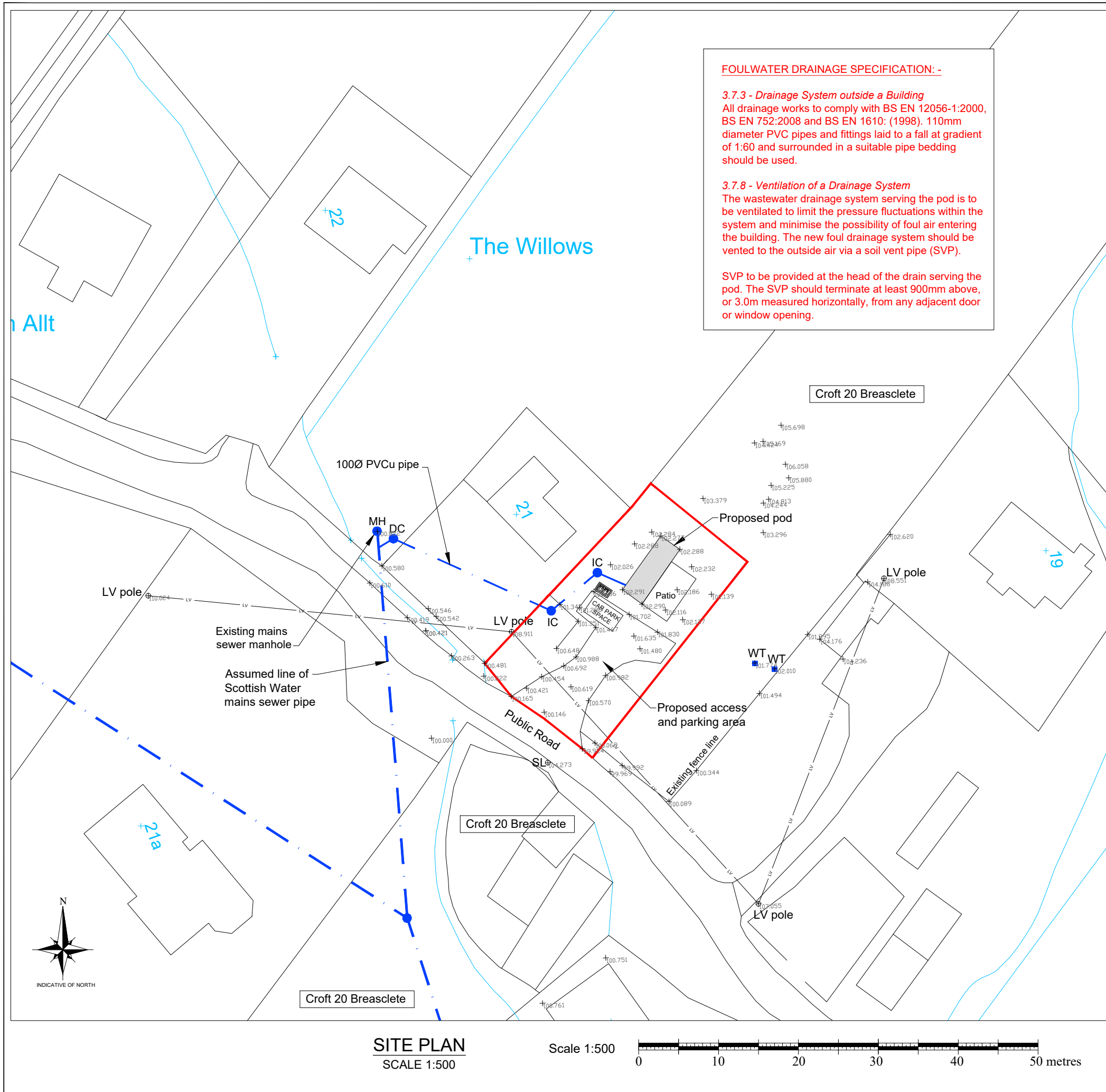

FOULWATER DRAINAGE SPECIFICATION: -

3.7.3 - Drainage System outside a Building
 All drainage works to comply with BS EN 12056-1:2000, BS EN 752:2008 and BS EN 1610: (1998). 110mm diameter PVC pipes and fittings laid to a fall at gradient of 1:60 and surrounded in a suitable pipe bedding should be used.

3.7.8 - Ventilation of a Drainage System
 The wastewater drainage system serving the pod is to be ventilated to limit the pressure fluctuations within the system and minimise the possibility of foul air entering the building. The new foul drainage system should be vented to the outside air via a soil vent pipe (SVP).

SVP to be provided at the head of the drain serving the pod. The SVP should terminate at least 900mm above, or 3.0m measured horizontally, from any adjacent door or window opening.

SITE PLAN
SCALE 1:500

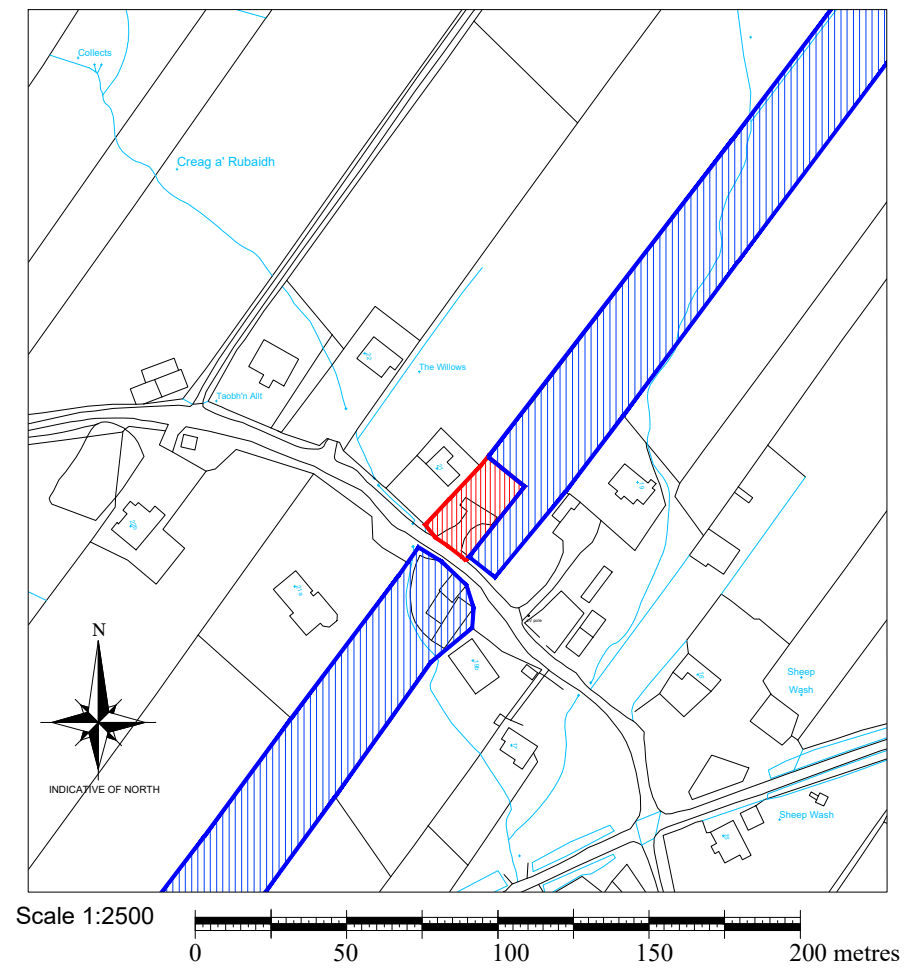

LOCATION PLAN
SCALE 1:2500

LEGEND

DC = Disconnecting chamber
 IC = Inspection chamber
 MH = Manhole
 RE = Rodding eye
 *83.00 = Spot level (m)
 — 110mm PVCu foulwater pipe
 ■ WT Existing water toby

FOR APPROVAL

Rev	By	Chkd	Apprvd	Date	Description

TOTAL DESIGN (LIGHTHILL) LTD
 Baird, 68 Lighthill,
 Back, Isle of Lewis
 HS2 0LF
 Tel: 01851 827 137 Mob: 07917 806 013 Email: totaldesign@sky.com

Applicant:
 -

Project: **Proposed pod, 20 Breascleite, Isle of Lewis**

SITE AND LOCATION PLANS

Drawn by: D MacLeod	Date: 08.07.24
Checked by:	Date:
Approved by: -	Date: -
Drawing No. P1542-001	Revision 00

- Notes:**
- 1) This drawing to be read in conjunction with the relevant specification and all other relevant drawings.
 - 2) All dimensions and levels to be checked on site and any discrepancies identified prior to commencement of work.
 - 3) All dimensions in metres unless otherwise noted.
 - 4) All levels in metres unless otherwise noted.
 - 5) It is the responsibility of the applicant to inform landowners and seek the necessary permission(s) for the proposed foulwater route.
 - 6) It is the responsibility of the applicant/owner to undertake the necessary trial holes to establish if ground conditions are suitable along the extent of the foulwater pipe line.

Drawing Scale: AS NOTED @ A3

J A MURDOCH PODS ASKERNISH, SOUTH UIST

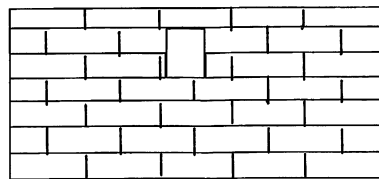
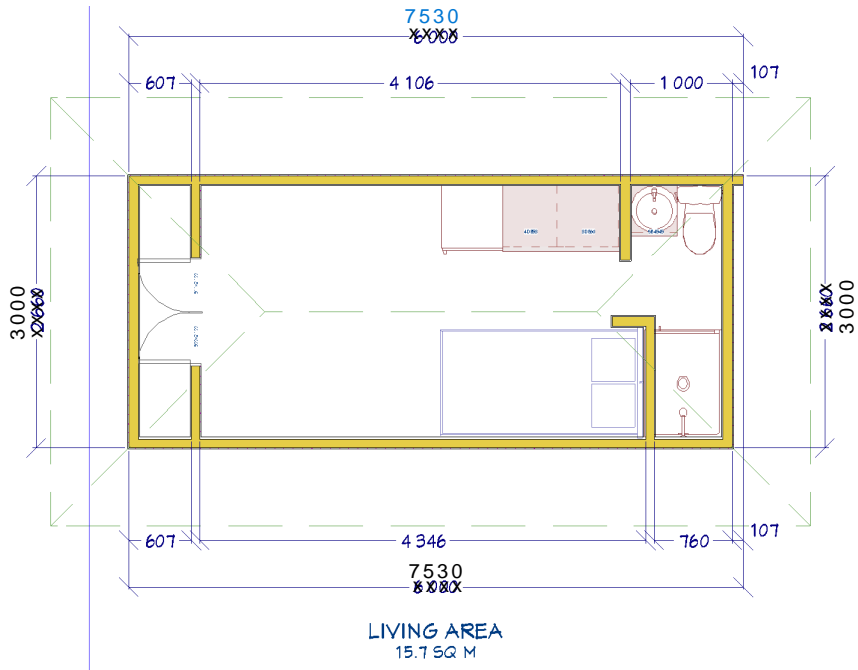

SIDE ELEVATION

6 METRES

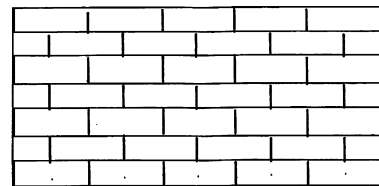

SIDE ELEVATION

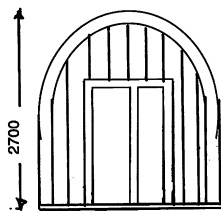

FRONT ELEVATION

3000

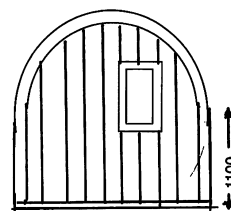

REAR ELEVATION

1100