



COMHAIRLE NAN EILEAN SIAR

The Town and Country Planning Scotland Act 1997 – Section 36(1)

Town and Country Planning General Development Procedure Order 2013 Regulation 16

Planning Register - Part 1

Application Details

Reference Number	24/00247/PPD
Date registered as valid	02/07/24
Description of Development	Create access from A859 road to existing compound (retrospective)
Address or description of location to which the development relates	Keltbray Site, Lochs Road, Lochs, Isle of Lewis
Co-ordinates	E 137 610, N 929 742
Applicant Name	KeltBray per Mr Rhys Mulligan
Applicant Address	Unit 12, Crewe Hall Enterprise Park, Cheshire, CW1 6UA
Agent name (if applicable)	Donald Mackay, CalMax Construction Limited
Agent address (if applicable)	1 Blackwater, Newmarket, Isle of Lewis, HS2 0EE

The above application summary is accompanied by plans and drawings sufficient to describe the development and where relevant any design statement.

Important Note: on Tuesday 07 November 2023, Comhairle nan Eilean Siar experienced a criminal cyber incident and is working with Police Scotland, the Scottish Government and the National Cyber Security Centre to investigate the matter.

The Online Planning Portal remains unavailable as does our suite of integrated software and hardware systems. In order to enable access by the wider public to application documents and consult upon planning applications, interim systems have been put in place on the temporary website of Comhairle nan Eilean Siar, including a rudimentary facility to display a limited number of documents per application.

Any party wishing to view the application file in full may do so at the offices of Comhairle nan Eilean Siar at Sandwich Road, Stornoway Isle of Lewis, HS1 2BW or Balivanich, Isle of Benbecula. HS7 5LA, ordinarily between 9am and 5pm Monday to Friday (excluding public and local holidays). It is recommended that in advance of visiting an office to view an application that you make an appointment by sending an email to planning@cne-siar.gov.uk

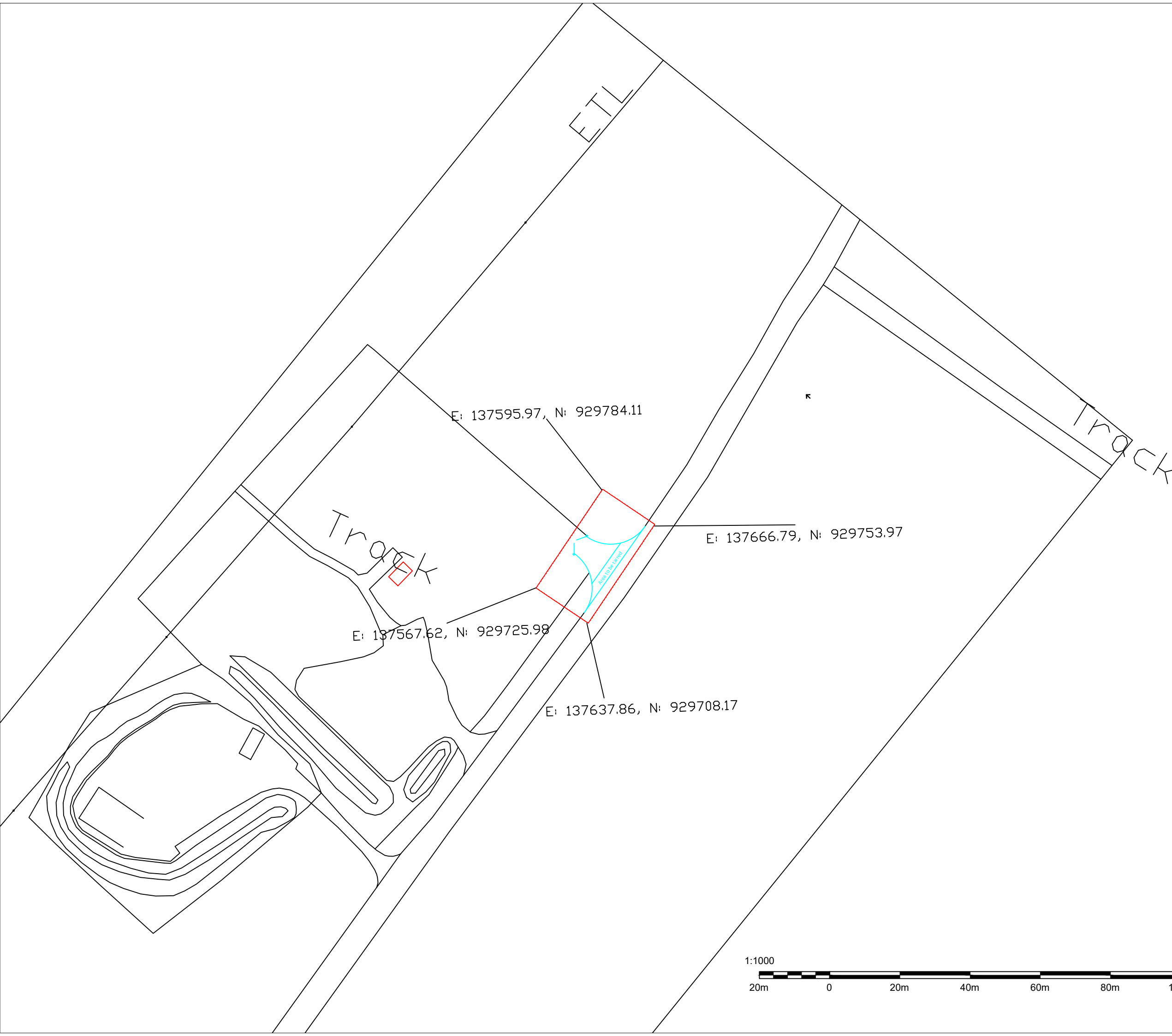

No.	Revision Note	Date

CalMax
Construction limited

Client:
KeltBray

Drawing Title:
KeltBray - Access Path

Project:
Kelt Bray, sub contract Access path

Drawing Scale: AS SHOWN	Drawn By : SM Date : 02/07/2024
----------------------------	------------------------------------

1 Blackwater, Newmarket
Isle Of Lewis, HS2 OEE

Tel: (01851) 700007
Fax: (01851) 701122

Drawing No: KL002/PL/001