



COMHAIRLE NAN EILEAN SIAR

The Town and Country Planning Scotland Act 1997 – Section 36(1)

Town and Country Planning General Development Procedure Order 2013 Regulation 16

Planning Register - Part 1

Application Details

Reference Number	24/00200/PPD
Date registered as valid	29/05/2024
Description of Development	Erect cycle shelter and stands
Address or description of location to which the development relates	Cycle Shelter, South Beach Quay, Stornoway, Isle of Lewis
Co-ordinates	N 932 739, E 142 377
Applicant Name	HITRANS Per Miss Vikki Trelfer
Applicant Address	Town House, 1 High Street, Inverness, IV1 1JJ
Agent name	N/A
Agent Address	N/A

The above application summary is accompanied by plans and drawings sufficient to describe the development and where relevant any design statement.

Important Note: on Tuesday 07 November 2023, Comhairle nan Eilean Siar experienced a criminal cyber incident and is working with Police Scotland, the Scottish Government and the National Cyber Security Centre to investigate the matter.

The Online Planning Portal remains unavailable as does our suite of integrated software and hardware systems. In order to enable access by the wider public to application documents and consult upon planning applications, interim systems have been put in place on the temporary website of Comhairle nan Eilean Siar, including a rudimentary facility to display a limited number of documents per application.

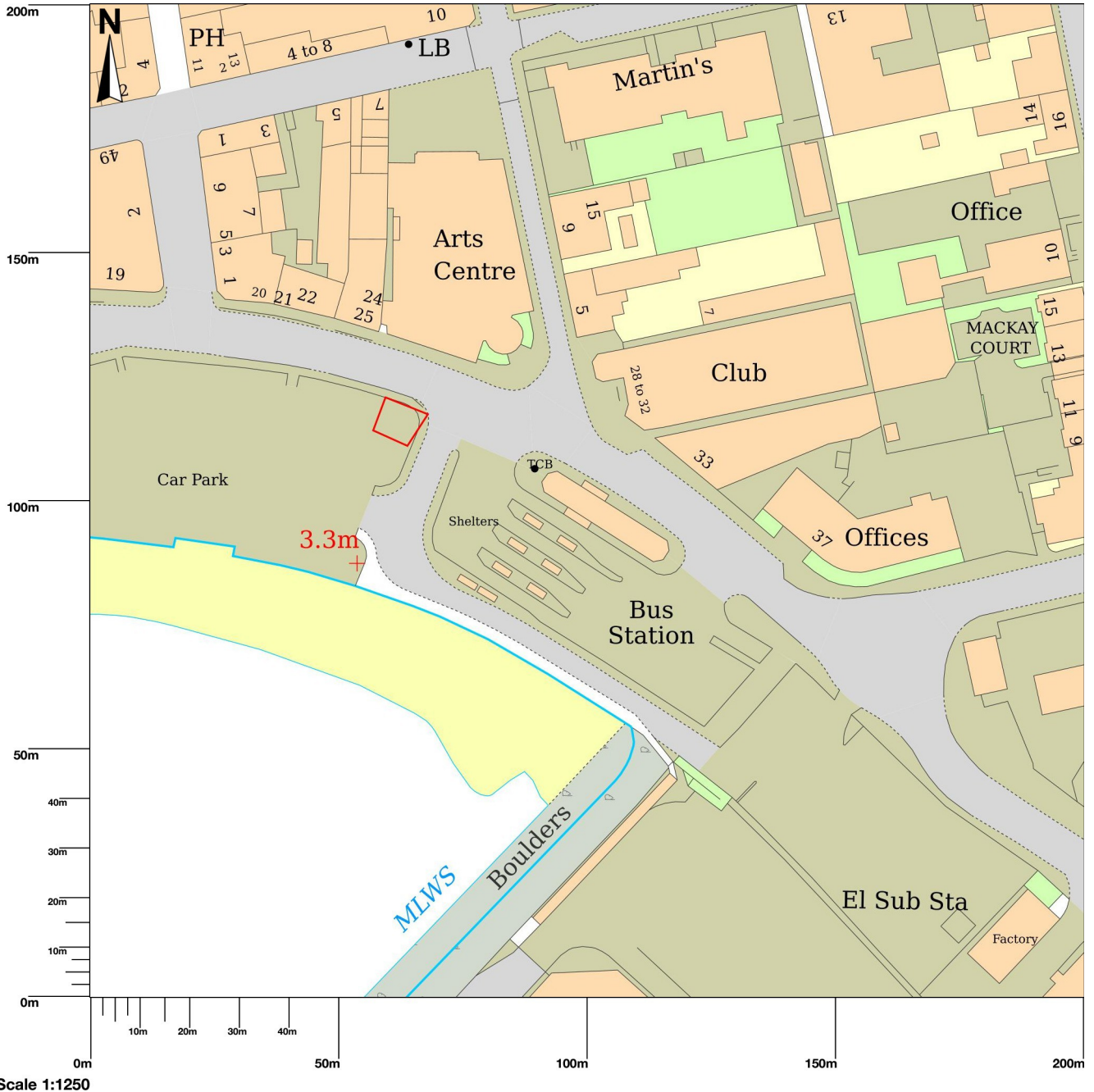

Any party wishing to view the application file in full may do so at the offices of Comhairle nan Eilean Siar at Sandwick Road, Stornoway Isle of Lewis, HS1 2BW or Balivanich, Isle of Benbecula. HS7 5LA, ordinarily between 9am and 5pm Monday to Friday (excluding public and local holidays). It is recommended that in advance of visiting an office to view an application that you make an appointment by sending an email to planning@cne-siar.gov.uk

Stornoway Bus Station, South Beach Quay, Stornoway, HS1 2BT

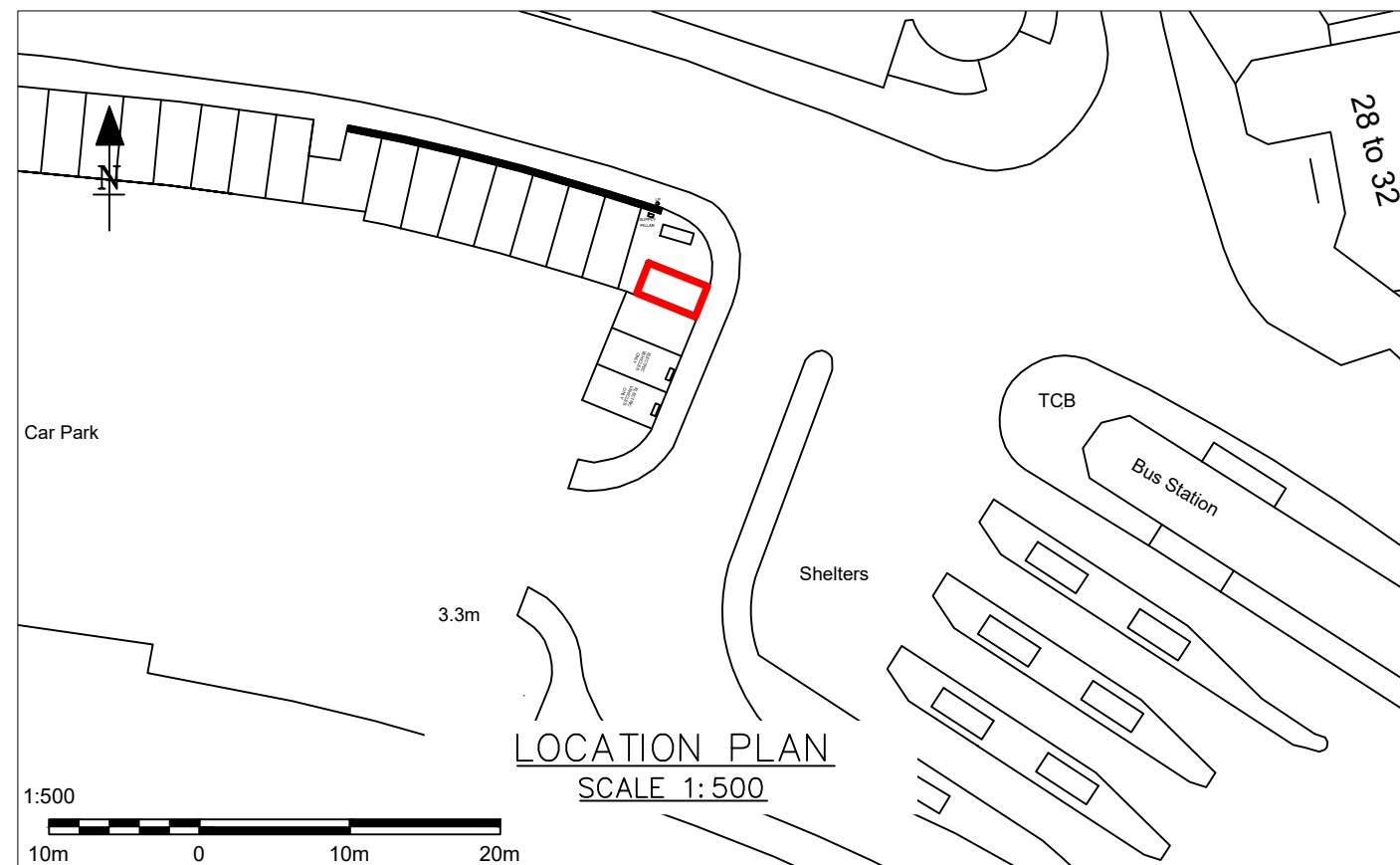
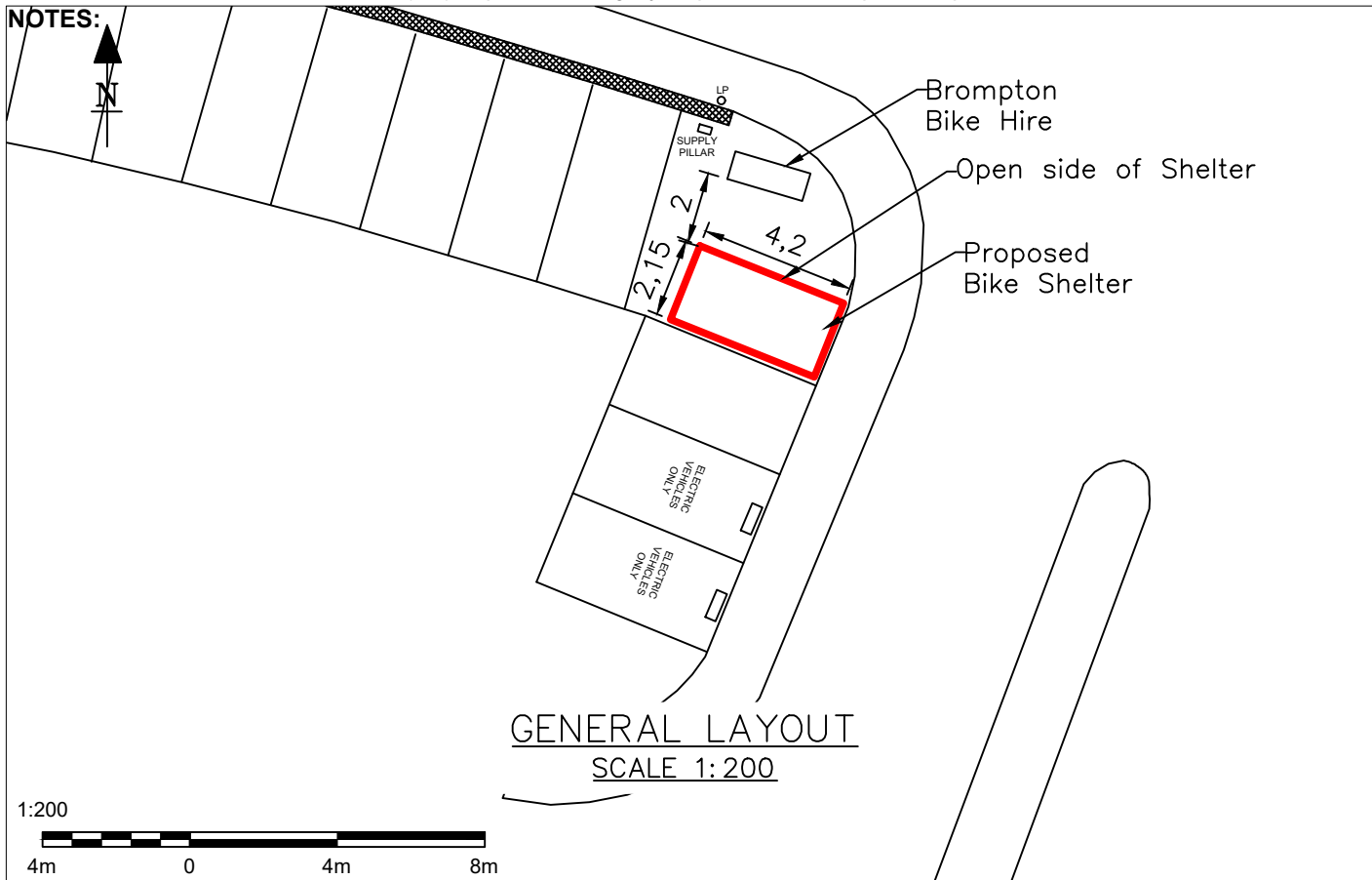

Do not scale from this drawing; work to figured dimensions only. All existing dimensions to be checked on site. All discrepancies must be notified to the issuing office.
 This drawing is to be read in conjunction with all other relevant documentation, including that produced by other Comhairle Departments, consultants, sub-contractors and suppliers.
 © Comhairle nan Eilean Siar, Assets and Infrastructure (2024). No part of this drawing may be reproduced without their prior written permission.

NOTES:





COMHAIRLE NAN EILEAN SIAR
ASSETS AND INFRASTRUCTURE:
 Engineering Projects

Calum Mackenzie
 Chief Officer Assets & Infrastructure, Chief Executive's Department

Sandwick Road, Stornoway, HS1 2BW T: 01851 600501
 Balivanich, Benbecula, HS7 5LA T: 01870 602425

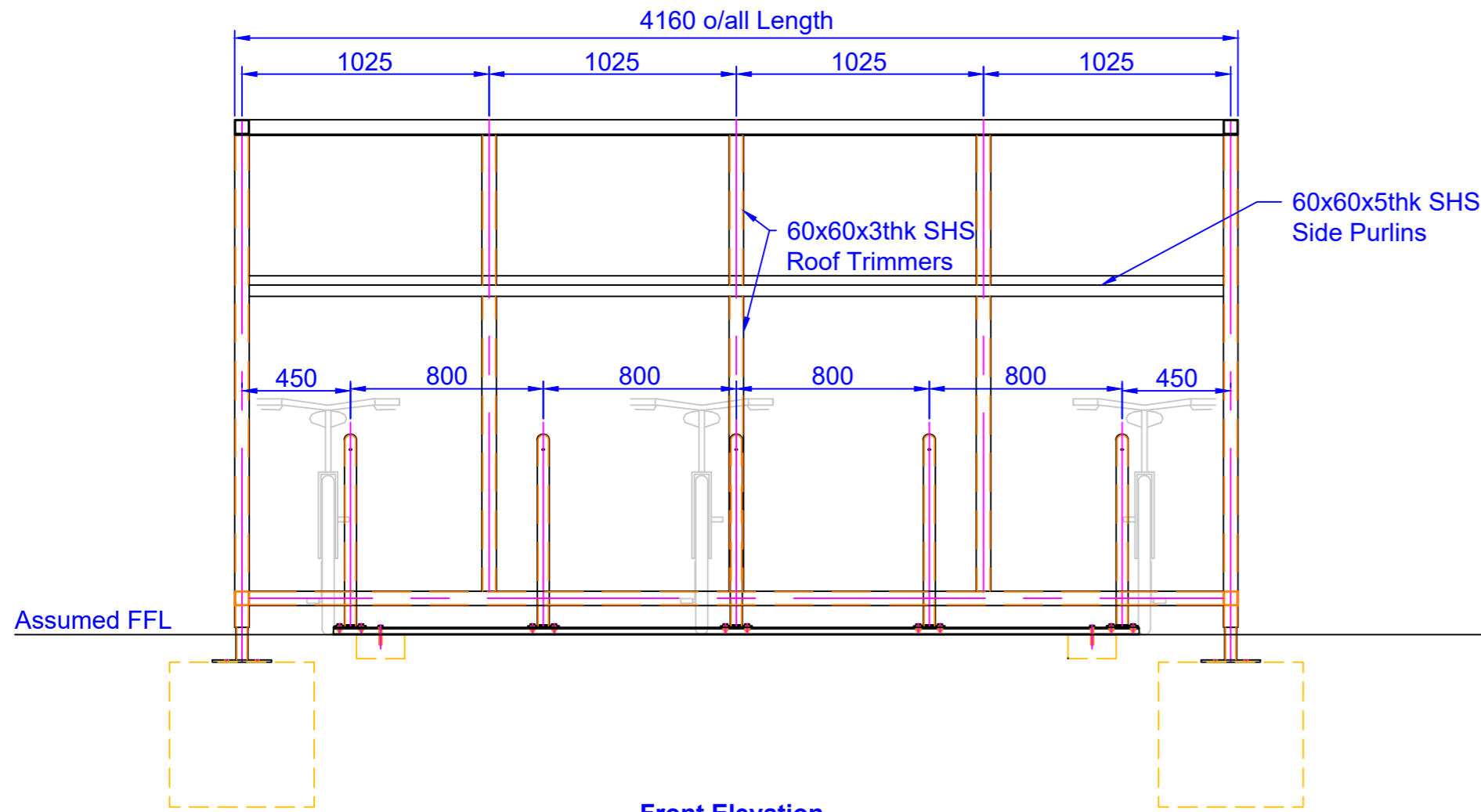
rev	description	drawn	ckd	date
Project No:		Scale: AS SHOWN	Original Size: A4	
Project: Bike Shelter Installation		Date: 22/05/24	Drawn: NI	
		Checked: NI		
Drawing: Location Plan and General Layout		DRAWING No. (6A 30) 001		Rev:



Front Elevation
Scale- 1:25

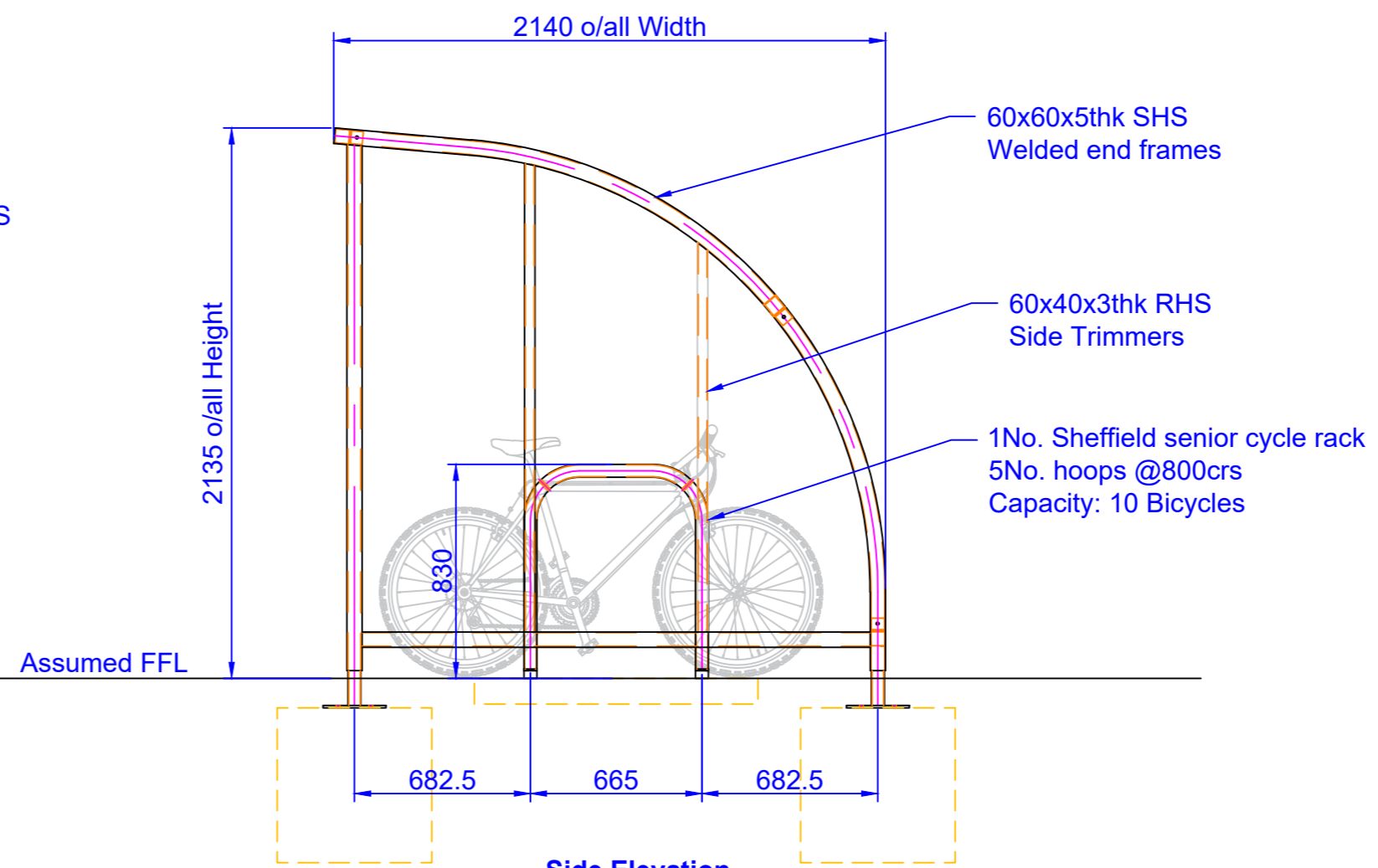

Side Elevation
Scale- 1:25

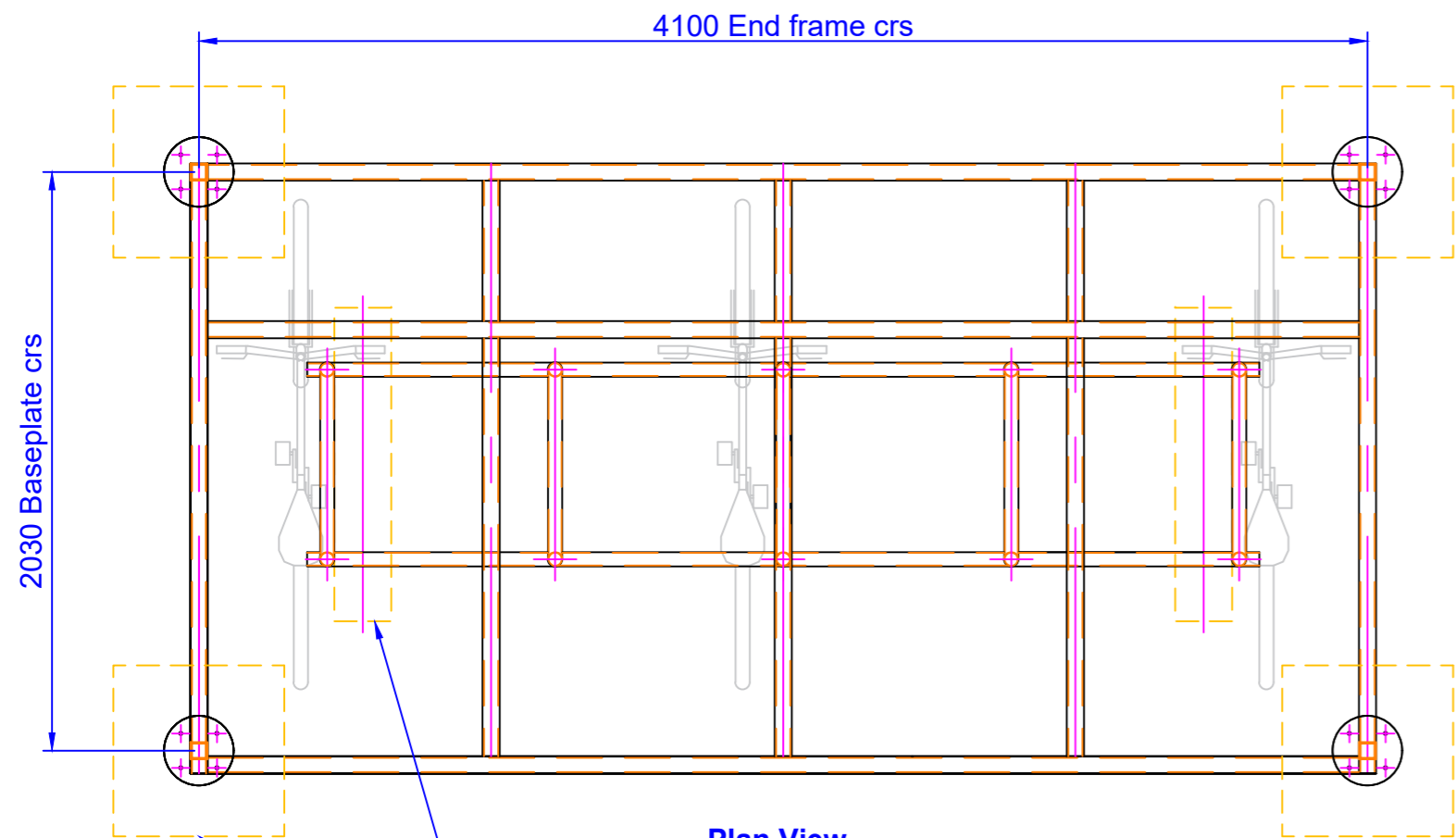

Plan View
Scale- 1:25

Please Note:
Foundations to be designed and installed by others
Foundations shown on Broxap drawing are indicative only

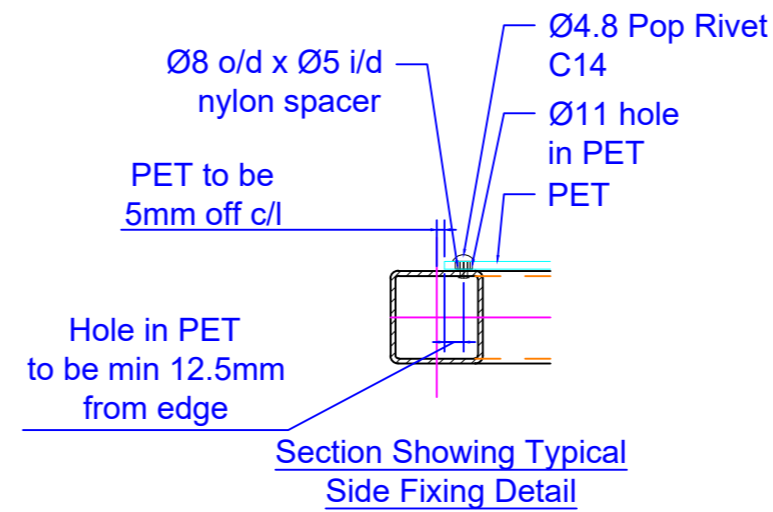

Section Showing Typical Side Fixing Detail

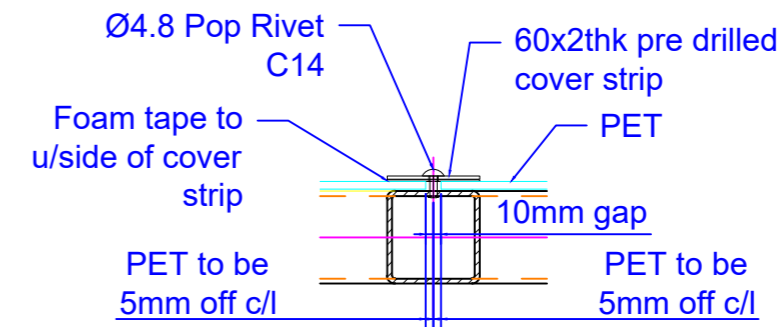

Section Showing Typical Jointing Detail

Spacer inclusion is essential in PET to allow for expansion/ contraction of cladding material
It is also essential that the drill hole diameter is as per drawing in order to ensure that spacers are allowed to work in conjunction with hole clearance
Failure to achieve any of the above scenarios will likely result in reduced longevity and performance of the cladding invalidating any Broxap or cladding manufacture warranty on this component

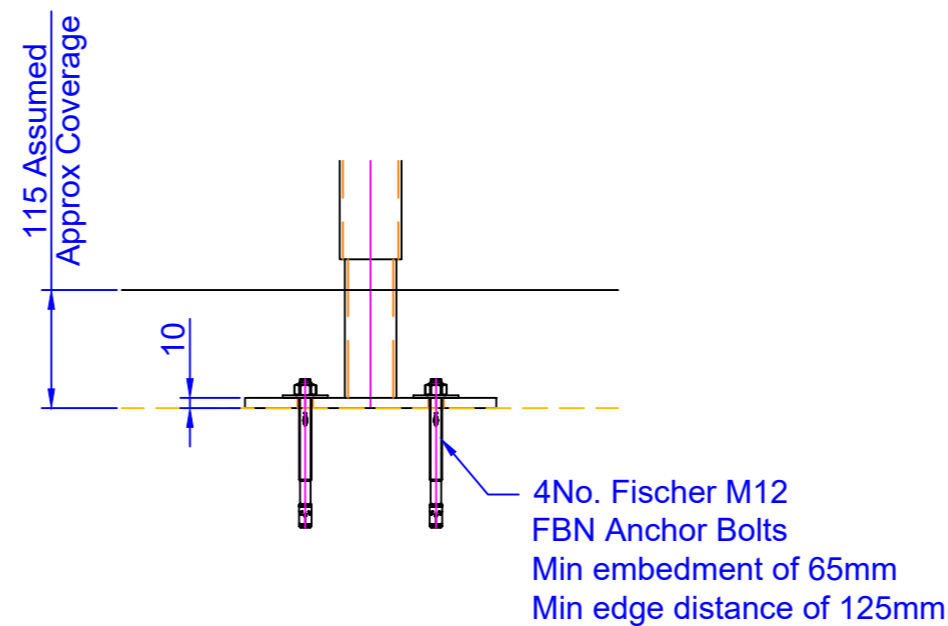

Typical Baseplate Fixing Detail
Scale- 1:7.5

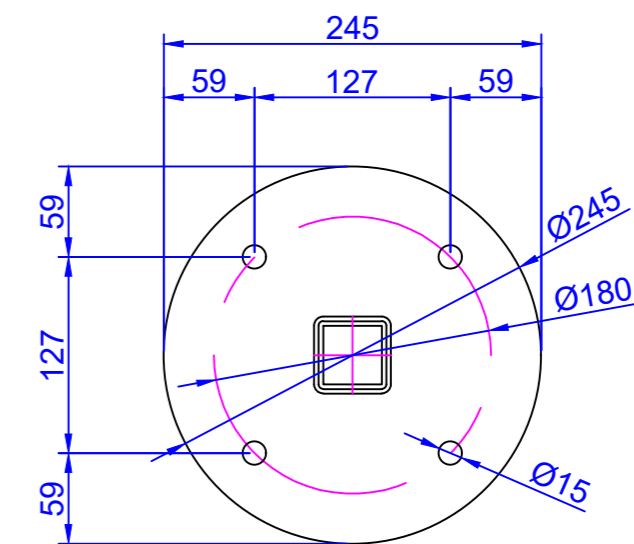

Typical Baseplate Detail
Scale- 1:5

General Notes:
All dimensions are to be checked on site with allowances for variations due to normal manufacturing tolerance.

Drawing errors or omissions are to be reported and checked with the Design Office.

Where items are drawn as assemblies these items must be trial assembled in workshop by manufacturer to ensure correct fit.

None of the work content shown in this drawing for any company may proceed until approved copies are distributed and clearly marked "ISSUED FOR CONSTRUCTION"

This drawing is copyright and no portion should be copied or reproduced without the consent of Broxap Limited

Fabrication Tolerances
0mm - 1000mm = +/- 1.0mm
1001mm - 2500mm = +/- 1.5mm
2501mm - 5000mm = +/- 2.0mm
5001mm - 10000mm = +/- 2.5mm
Unless stated otherwise

Project Specific Notes:
Shelter galvanised in accordance with BS EN ISO 1461:2009
Finish colour to be GALV ONLY
Roof cladding to be 5mm PETg
Cladding colour to be CLEAR

Installation Notes:
Shelwork to be installed to BS 5606:1990
Columns position +/- 10mm per bay
Column Verticality +/- 5mm
Level at Eave +/- 5mm
Overall length +/- 5mm

Foundations to be designed and installed by others
Please note that due a survey not being performed by Broxap,

the position of the shelter is to be advised by the client. The client must ensure that the location in which the shelter is to be installed is of sufficient size to enable the shelter to be fitted without complication or impediment from buildings, walls or any free standing structures in the vicinity. The client is also responsible for the legs of the shelter being positioned so not to foul with any drains, services, manhole covers or underground foundations.

Broxap Ltd may be contacted should you wish to discuss shelter location or site suitability, alternatively feel free to seek independent advice.

C	Additional Trimmers added & issued for construction variation	JC	PPR	25/09/20
B	Checked and issued for construction	JW	RJM	21/08/20
A	Issued for information	JBT	PPR	21/08/20
Rev	Description	Drawn	Checked	Date

Drawing Status:
Construction Issue



Design & Head Office, Rowhurst Industrial Estate,
Cheriton, Newcastle-under-Lyme, Staffordshire ST5 6BD
Tel: +44 (0) 1782 564111 Fax: +44 (0) 1782 564312

Client:
The Highland Council

Project:
Broom Place
Portree, Isle of Skye
IV51 9HL

Drawing Title:
General Arrangement
Standard Wardale Shelter

Drawn: JBT
Checked: PPR

Date: 21/08/20
Scale: see drg@ A2

Drawing No:
011069-00-1.000

Rev. No:
C

Broxap Order No: ORD00266555