



# COMHAIRLE NAN EILEAN SIAR

The Town and Country Planning Scotland Act 1997 – Section 36(1)

Town and Country Planning General Development Procedure Order 2013 Regulation 16

Planning Register - Part 1

## Application Details

Reference Number	24/00192/PPD
Date registered as valid	20 May 2024
Description of Development	New play area
Address or description of location to which the development relates	Play Area, Taigh Sgìre Sholais, North Uist
Applicant Name	Mrs Joan Ferguson, North Uist Community Council
Applicant Address	3 Claddach Kirkibost, North Uist
Agent name (if applicable)	David MacLeod, Total Design (Lighthill) Ltd
Agent address (if applicable)	Balard, 68 Lighthill, Back, Isle of Lewis

**The above application summary is accompanied by plans and drawings sufficient to describe the development and where relevant any design statement.**

Important Note: on Tuesday 07 November 2023, Comhairle nan Eilean Siar experienced a criminal cyber incident and is working with Police Scotland, the Scottish Government and the National Cyber Security Centre to investigate the matter.

The Online Planning Portal remains unavailable as does our suite of integrated software and hardware systems. In order to enable access by the wider public to application documents and consult upon planning applications, interim systems have been put in place on the temporary website of Comhairle nan Eilean Siar, including a rudimentary facility to display a limited number of documents per application.

Any party wishing to view the application file in full may do so at the offices of Comhairle nan Eilean Siar at Sandwich Road, Stornoway Isle of Lewis, HS1 2BW or Balivanich, Isle of Benbecula. HS7 5LA, ordinarily between 9am and 5pm Monday to Friday (excluding public and local holidays). It is recommended that in advance of visiting an office to view an application that you make an appointment by sending an email to [planning@cne-siar.gov.uk](mailto:planning@cne-siar.gov.uk)

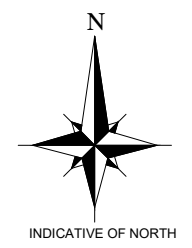
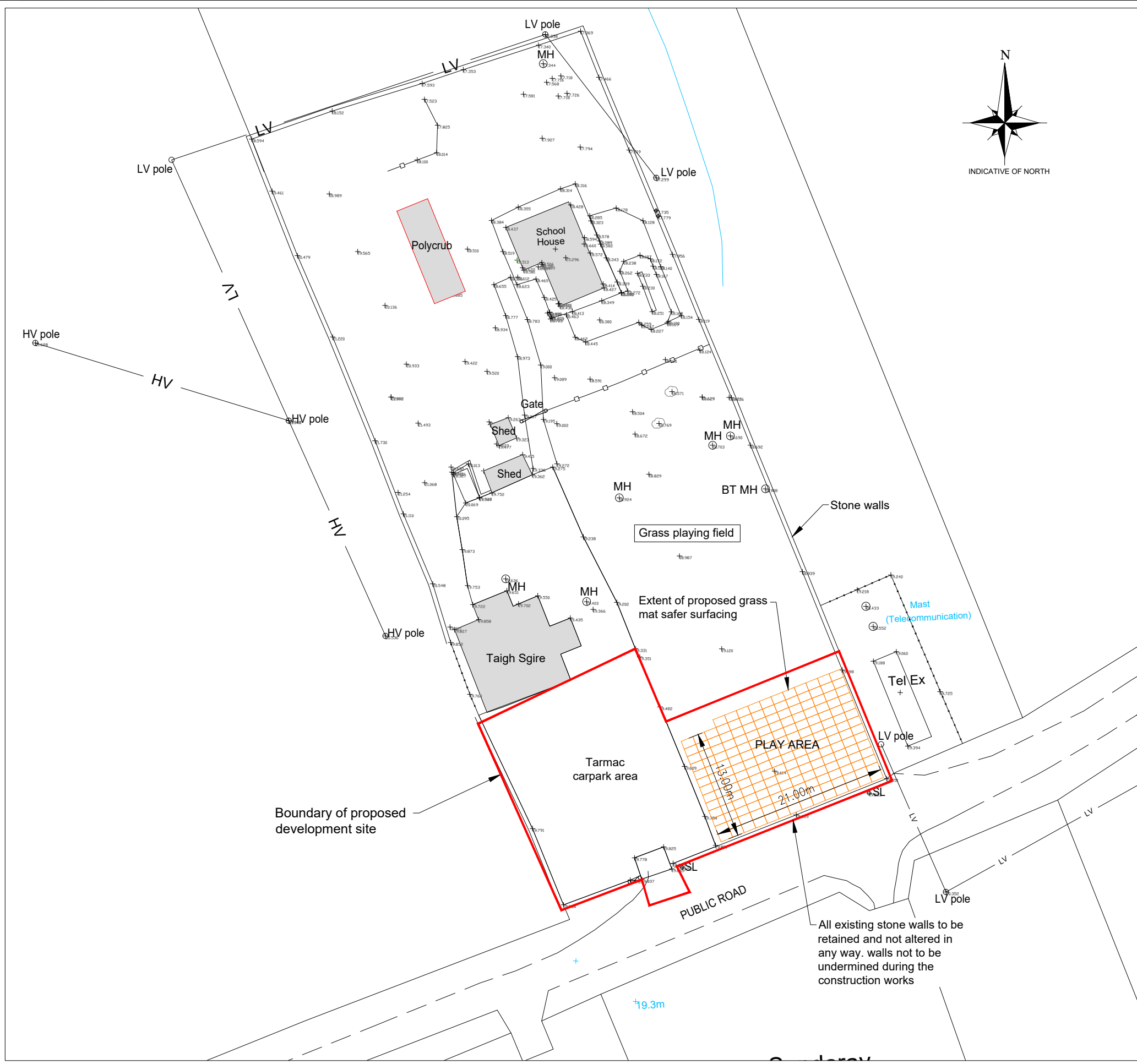

**SITE PLAN**  
SCALE 1:500

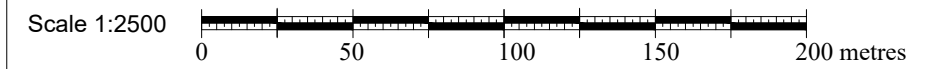
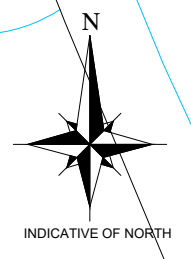
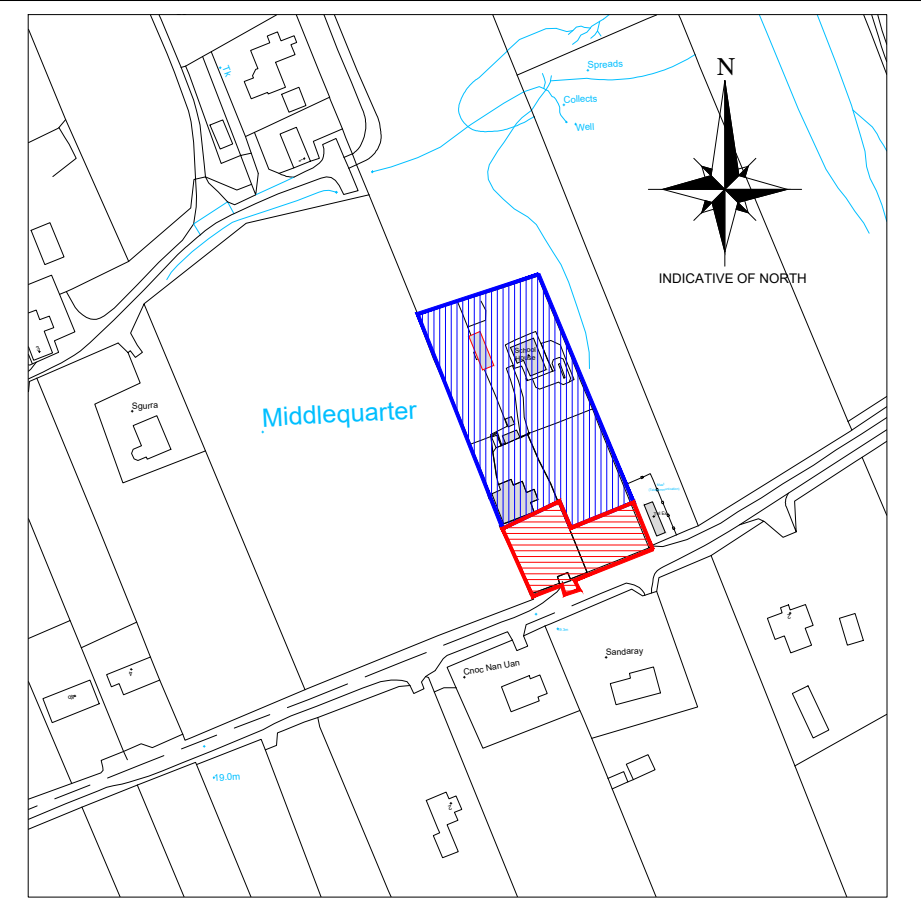
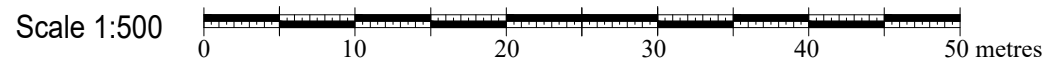

**LOCATION PLAN**  
SCALE 1:2500

PROPOSED DEVELOPMENT SITE  
 AREA OF LAND CONTROL

**LEGEND**

- DC = Disconnecting chamber
- IC = Inspection chamber
- MH = Manhole
- RE = Rodding eye
- \* 83.00 = Spot level (m)
- = rainwater drainage (110mm PVCu pipes) to outfall into soakaway, 1.5m<sup>3</sup> per 100m<sup>2</sup> of roof area
- = 110mm PVCu foulwater pipe
- = 110mm PVCu rainwater pipe
- = Existing water main (2" AC)
- WT Water toby

- Notes:**
- 1) This drawing to be read in conjunction with the relevant specification and all other relevant drawings.
  - 2) All dimensions and levels to be checked on site and any discrepancies identified prior to commencement of work.
  - 3) All dimensions in metres unless otherwise noted.
  - 4) All levels in metres unless otherwise noted. Levels relative to an approx. OS datum of 22m at survey station 1000.
  - 5) It is the responsibility of the applicant to inform landowners and seek the necessary permission(s) for the proposed foulwater route.
  - 6) It is the responsibility of the applicant/owner to undertake the necessary trial holes to establish if ground conditions are suitable along the extent of the foulwater pipe line.

**FOR APPROVAL**

00	DM	14.05.24	ISSUED FOR PLANNING APPROVAL
Rev	By	Chkd	Apprvd
			Date
			Description

**TOTAL DESIGN (LIGHTHILL) LTD**  
Ballard, 68 Lighthill,  
Black Isle of Lewis  
HS2 0LF  
Tel: 01851 827 137 Mob: 07917 806 013 Email: totaldesign@sky.com

**Applicant:**  
**Taigh Sgire Sholais**

Project  
Detailed Planning Permission  
Proposed play area, Taigh Sgire,  
Middlequarter, Sollas, Isle of North Uist

Drawing  
**SITE AND LOCATION PLANS**

Drawn by: D MacLeod	Date: 23.04.24
Checked by:	Date:
Approved by: -	Date: -
Drawing No.	Revision
<b>P1522-001</b>	<b>00</b>
Drawing Scale: AS NOTED @ A3	

**GRASS MAT SAFER SURFACING**  
 tested in accordance with BS EN1177 & EN7188  
 1m x 1.5m, 22mm thick  
 supplied with turf reinforcement mesh  
 Grass areas should be well established prior to grass mat safety surfacing being laid

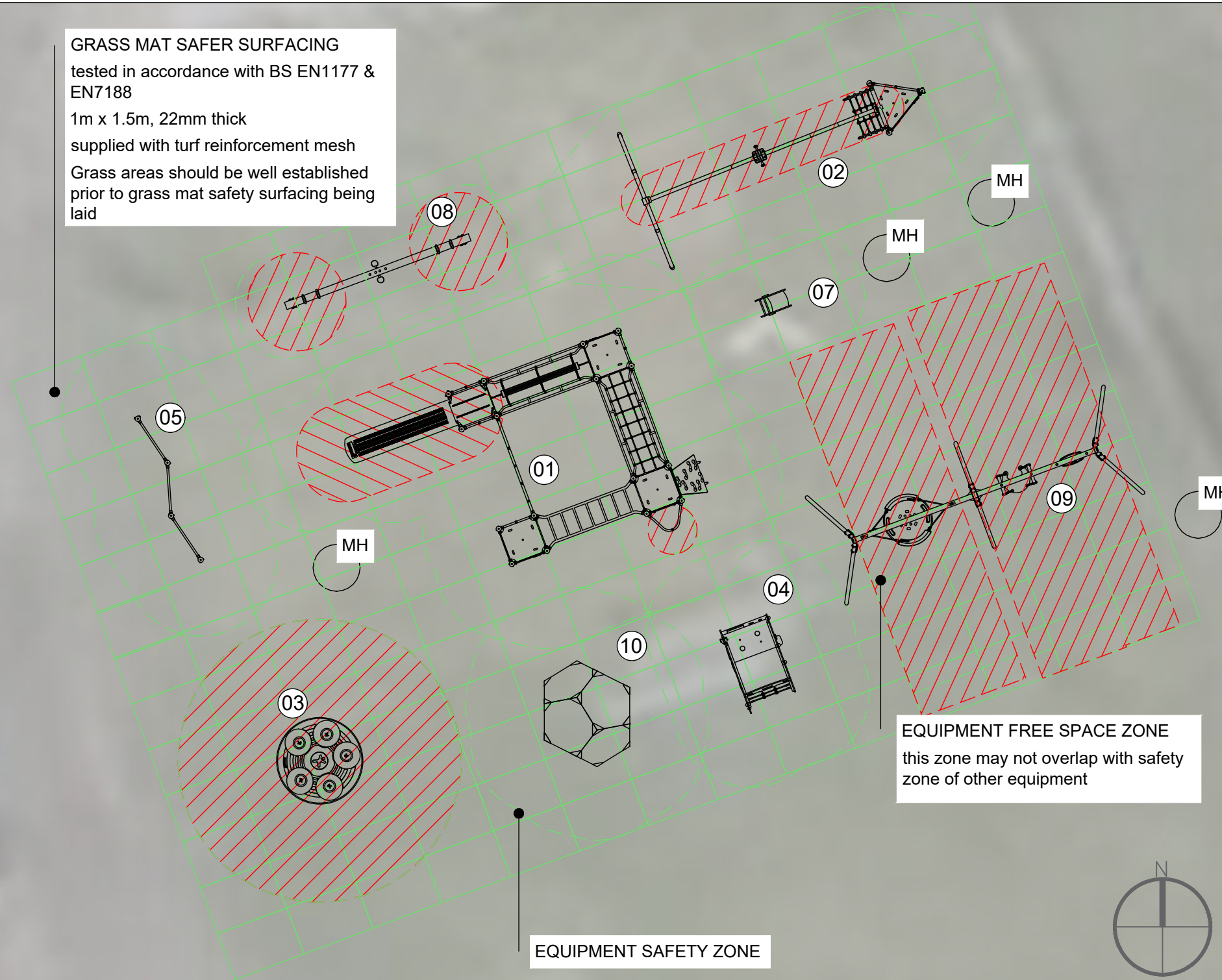

**EQUIPMENT FREE SPACE ZONE**  
 this zone may not overlap with safety zone of other equipment

**EQUIPMENT SAFETY ZONE**

	Product Number	Product Name	Fall Height	Age	Count
01	PCM410421	Four Tower with Bridges	224 cm	4+	1
02	PCM110321	Track Ride Tower	118 cm	6+	1
03	ELE400060	Multispinner Carousel	100 cm	3+	1
04	MSC541600	Forest Giraffe	56 cm	6m+	1
05	PCM803	Triple Somersault Bars	148 cm	4+	1
06	FAZ302	Step Up, 40cm	38 cm	13+	1
07	M12301	Crazy Nellie	60 cm	1+	1
08	NRO106	Entry Seesaw, 4 Persons	115 cm	4+	1
09	KSW904	Combination Swing	148 cm	2+	1
10	BLX410102	BLOQX 1	205 cm	6+	1

REV A - HB - Change of equipment, based on client request - 25.03.2024

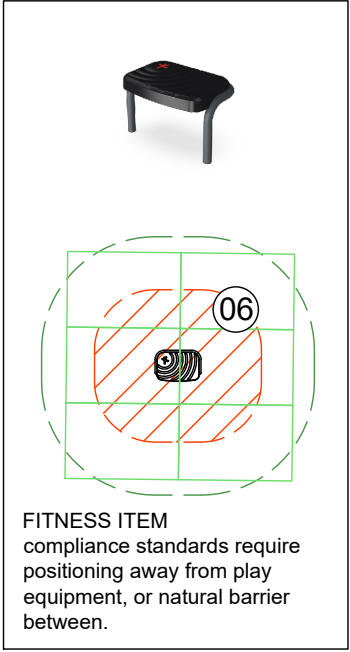

**FITNESS ITEM**  
 compliance standards require positioning away from play equipment, or natural barrier between.

**\*\*SUPPLY ONLY\*\***  
 For location of play area ref. Architects drawing  
 For details of soft landscaping ref. Landscape Architects drawing  
 Design assumes the site will be levelled by others(max. gradient 1:100), free draining and with good access  
 Quotation and design is submitted site unseen, we reserve the right, following a full site survey to amend the design appropriately.  
 Areas and dimensions shown are critical for compliance with European safety standards En1176 & En1177, If in doubt ask!  
 Grass areas should be well established prior to grass mat safety surfacing being laid.



**KOMPAN**  
 Let's play

KOMPAN Scotland Ltd. www.KOMPAN.co.uk  
 Quarrywood Court T:01506 442 266  
 Livingston E:kompan.scotland@kompan.com  
 EH54 6AX

**NOT FOR TENDER ISSUE.**  
 ©copyright of this drawing remains the property of KOMPAN Scotland Ltd. and the KOMPAN group. This drawing may not be reproduced without prior permission of KOMPAN Scotland Ltd. Any infringement will be pursued.

Project North Uist Play Area	Designed by HB
Client Taigh Sgìre Sholais	Date 25.03.2024
Title General Layout	Scale 1:100@A3
	Revision A