



COMHAIRLE NAN EILEAN SIAR

The Town and Country Planning Scotland Act 1997 – Section 36(1)

Town and Country Planning General Development Procedure Order 2013 Regulation 16

Planning Register - Part 1

Application Details

Reference Number	24/00132/PPD
Date registered as valid	27/03/24
Description of Development	Alterations to existing driveway to new Scaliscro Lodge Building
Address or description of location to which the development relates	Scaliscro New Lodge, Uig, Isle of Lewis, HS2 2EL
Co-ordinates	E 113 789 N 926 920
Applicant Name	Scaliscro Estates Limited
Applicant Address	Fowler Fortescue, The Old Dairy, Fonthill Bishop, Nr Salisbury SP3 5SH
Agent name (if applicable)	Porteous Architecture Per Fiona Porteous
Agent address (if applicable)	9 Bank Street, Stornoway, Isle of Lewis, HS1 2XG

The above application summary is accompanied by plans and drawings sufficient to describe the development and where relevant any design statement.

Important Note: on Tuesday 07 November 2023, Comhairle nan Eilean Siar experienced a criminal cyber incident and is working with Police Scotland, the Scottish Government and the National Cyber Security Centre to investigate the matter.

The Online Planning Portal remains unavailable as does our suite of integrated software and hardware systems. In order to enable access by the wider public to application documents and consult upon planning applications, interim systems have been put in place on the temporary website of Comhairle nan Eilean Siar, including a rudimentary facility to display a limited number of documents per application.

Any party wishing to view the application file in full may do so at the offices of Comhairle nan Eilean Siar at Sandwick Road, Stornoway Isle of Lewis, HS1 2BW or Balivanich, Isle of Benbecula. HS7 5LA, ordinarily between 9am and 5pm Monday to Friday (excluding public and local holidays). It is recommended that in advance of visiting an office to view an application that you make an appointment by sending an email to planning@cne-siar.gov.uk

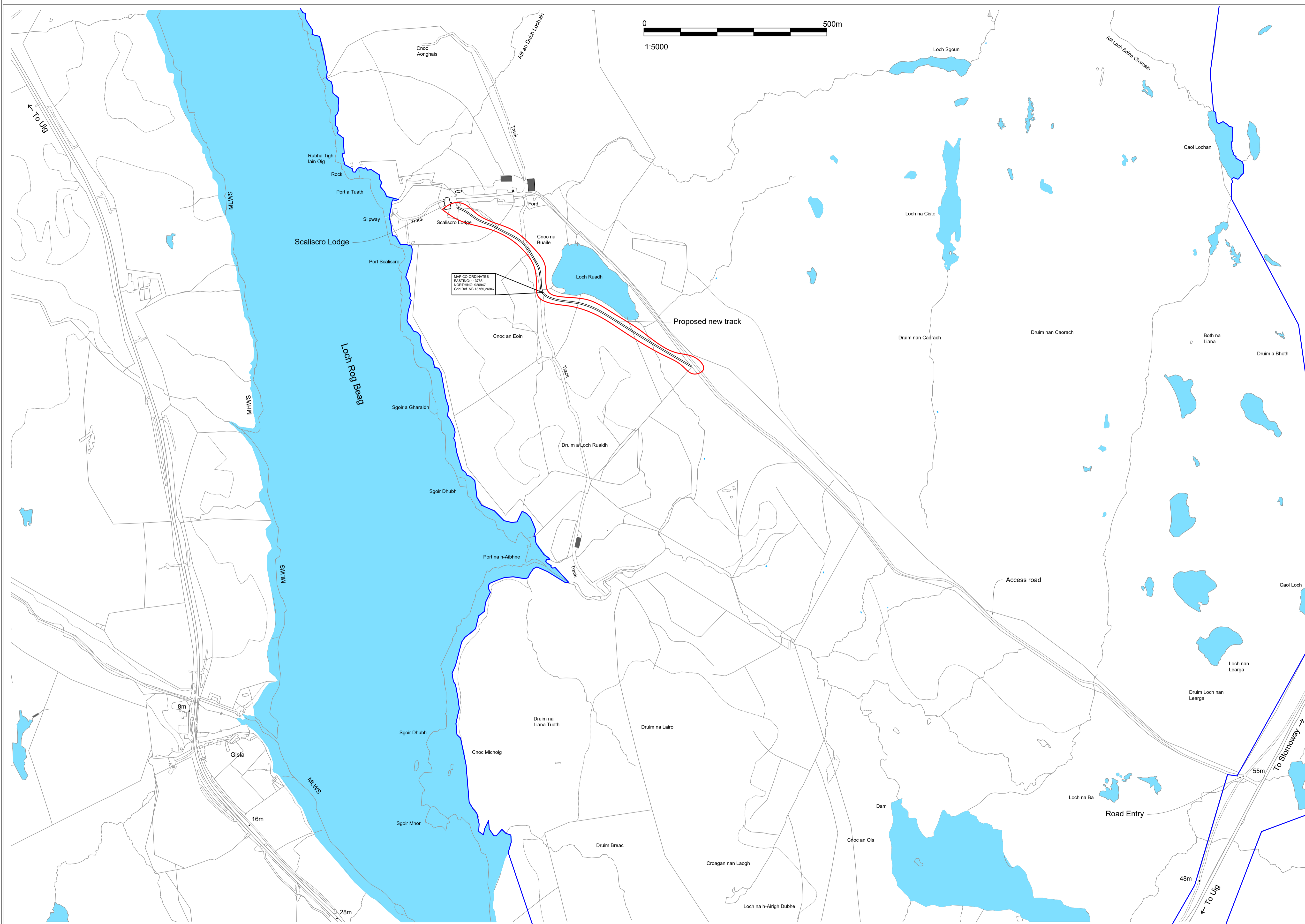

MAP CO-ORDINATES
 EASTING: 133765
 NORTHING: 505847
 Grid Ref: NB 13765 26947

PORTEOUS ARCHITECTURE LTD

NOTE:
 Do not scale drawing work to written dimensions only.
 Check dimensions on site. Clarify any discrepancies and ambiguities with Architect prior to commencement of works.
 Drawings to be read in conjunction with all relevant specifications and schedules.
 COPYRIGHT:
 Copyright in these drawings is the property of Porteous Architecture LTD. This shall remain the property of Porteous Architecture LTD and shall be returned on demand.
 The drawings and specifications must not be copied or used, disclosed or passed to any third parties for any purpose whatsoever without the express written consent of Porteous Architecture LTD.

HARRIS STUDIO
 STUDIO 4, TALLA NA MARA,
 PAIRC NISEABOIST,
 ISLE OF HARRIS, HS3 3AE,
 01859 550313

LEWIS STUDIO
 STORNOWAY BUSINESS HUB,
 9 BANK STREET, STORNOWAY,
 ISLE OF LEWIS, HS1 2XG
 tel: 01851860758

rev.	date	notes

**PROPOSED NEW LODGE HOUSE
 SCALISCRO LODGE
 UIG, ISLE OF LEWIS
 for
 SCALISCRO ESTATES LTD.**

**LOCATION PLAN
 PLANNING**

project:	21-12.2
date:	22.03.24
size:	A1
scale:	1:5000 @ A1
drawing:	P-01
revision:	

Duncan Porteous e: idporteous@aol.com m: 07766 075805
 Fiona Porteous e: fwaporteous@aol.com m: 07766 727039

www.porteousarchitecture.co.uk



NOTES:
 1. This drawing is to be read in conjunction with all relevant contract documentation from the design team, with any conflicting information to be brought to the attention of FFLO, in writing before commencing on site.
 2. The contractor is to check and verify all levels and dimensions before construction. Any discrepancies are to be brought to the attention of FFLO, in writing before commencing on site.
 3. All dimensions are in mm, unless otherwise stated.
 4. Do not scale from this drawing.
 5. All sub base and concrete specification, fixings, brackets & the like to Structural Engineers' details & specification.
 6. All proprietary products shall be installed in accordance with manufacturers written instructions.
 7. Read in conjunction with FFLO drawings.
 NB.
 For Design Intent Only. All Measurements to be checked on site.

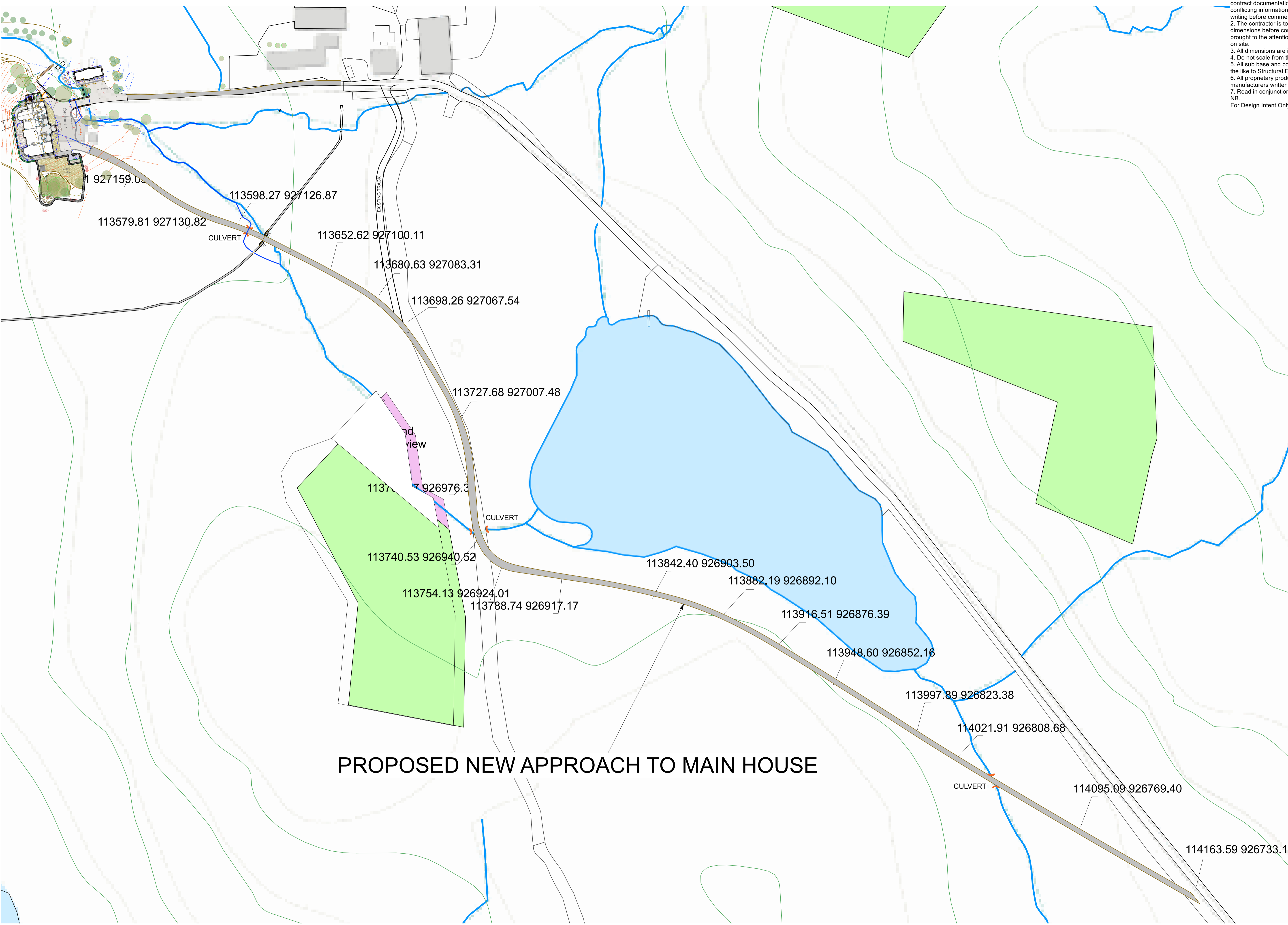

PROPOSED NEW APPROACH TO MAIN HOUSE

No. Date By Revision Notes

FFLO
 Fox Fernley Landscape Office,
 27 Upper Street,
 Tunbridge Wells, TN4 8NX
 Kent, TN48NX

Scalicro SCA-001-FFLO
 Scalicro Lewis

New Approach to House
 109 22/09/2023
 Purpose: FOR PLANNING
 By: DC

Scale 1:1000@A1



Typical Cross-section

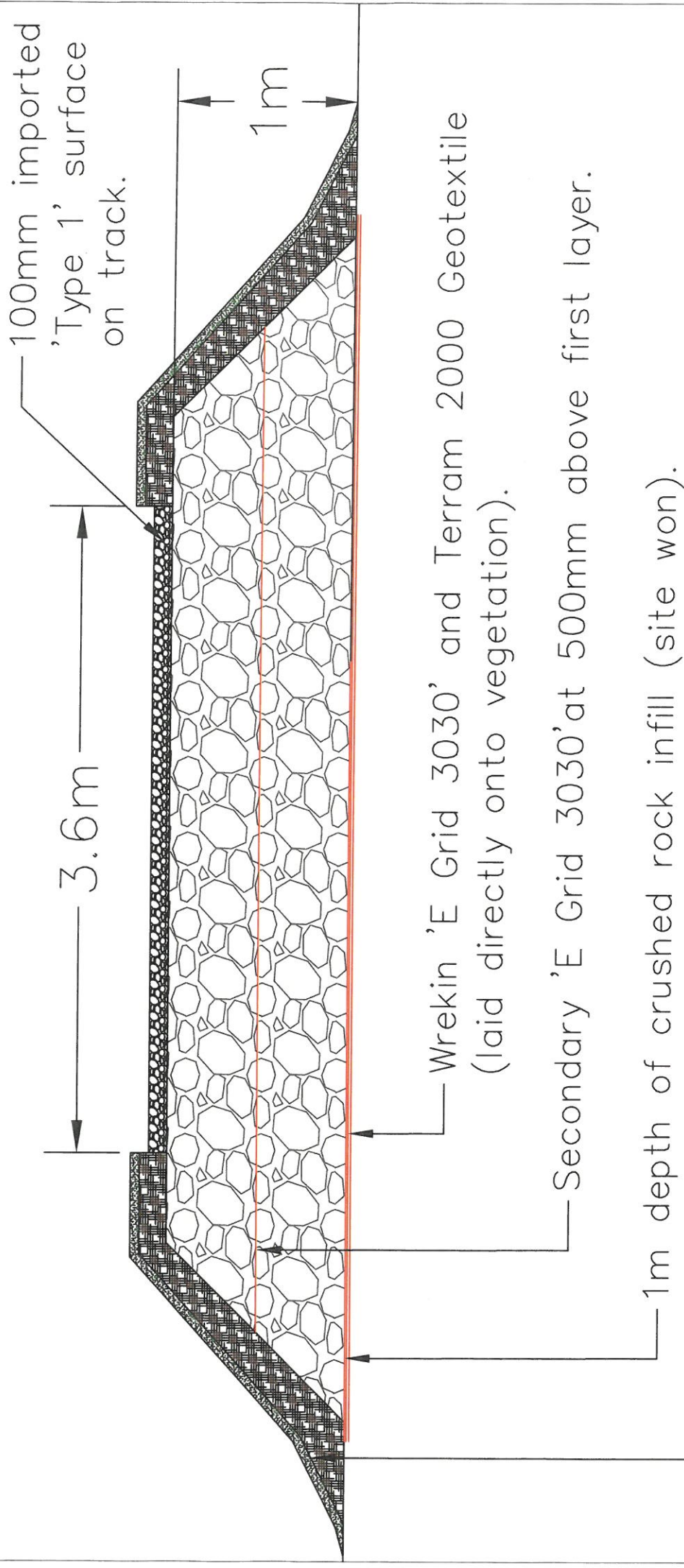

Verge and batter landscaping materials to floating sections to be obtained from areas of track to have 'dug to hard' construction