



COMHAIRLE NAN EILEAN SIAR

The Town and Country Planning Scotland Act 1997 – Section 36(1)

Town and Country Planning General Development Procedure Order 2013 Regulation 16

Planning Register - Part 1

Application Details

| | |
|---|-------------------------------------|
| Reference Number: | 24/00026/PPD |
| Date registered as valid: | 18 January 2024 |
| Description of Development: | Site Caravan |
| Address or description of location to which the development relates: | 244 Bruernish, Isle of Barra |
| Applicant Name: | Charmaine Parsons |
| Applicant Address: | Dumyat, Balirlogie, Stirling |
| Agent name (if applicable) | |
| Agent address (if applicable) | |

The above application summary is accompanied by plans and drawings sufficient to describe the development and where relevant any design statement.

Important Note: on Tuesday 07 November 2023, Comhairle nan Eilean Siar experienced a criminal cyber incident and is working with Police Scotland, the Scottish Government and the National Cyber Security Centre to investigate the matter.

The Online Planning Portal remains unavailable as does our suite of integrated software and hardware systems. In order to enable access by the wider public to application documents and consult upon planning applications, interim systems have been put in place on the temporary website of Comhairle nan Eilean Siar, including a rudimentary facility to display a limited number of documents per application.

Any party wishing to view the application file in full may do so at the offices of Comhairle nan Eilean Siar at Sandwick Road, Stornoway Isle of Lewis, HS1 2BW or Balivanich, Isle of Benbecula. HS7 5LA, ordinarily between 9am and 5pm Monday to Friday (excluding public and local holidays). It is recommended that in advance of visiting an office to view an application that you make an appointment by sending an email to planning@cne-siar.gov.uk

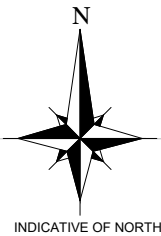

INDICATIVE OF NORTH

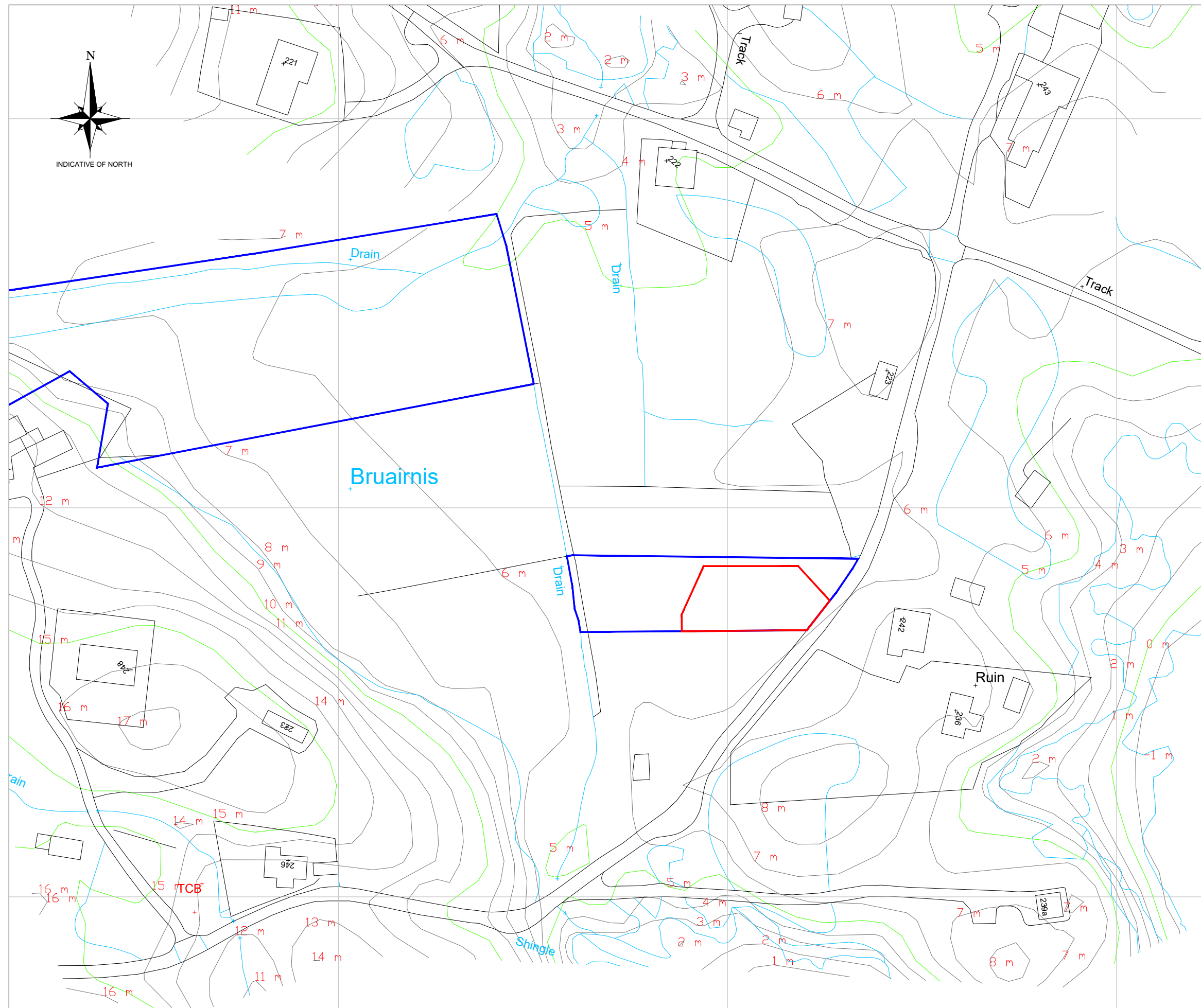

CONTOUR PLAN
SCALE 1:1000

Notes:

- 1) This drawing to be read in conjunction with the relevant specification and all other relevant drawings.
- 2) All dimensions and levels to be checked on site and any discrepancies identified prior to commencement of work.
- 3) All dimensions in metres unless otherwise noted.
- 4) All levels in metres unless otherwise noted.

| Rev | By | Chkd | Apprvd | Date | Description |
|-----|----|------|--------|------|-------------|
| | | | | | |

TOTAL DESIGN (LIGHTHILL) LTD
 Ballard, 68 Lighthill,
 Backgate of Lewis,
 HS2 0LF
 Tel: 01851 827 137 Mob: 07917 806 013 Email: totaldesign@sky.com

Applicant:
Charmaine Parsons

Project **DETAILED PLANNING**
 Site static caravan
 on croft 244 Bruairnis, Isle of Barra

Drawing **CONTOUR PLAN**

Drawn by: D MacLeod Date: 13.11.23
 Checked by: Date: -
 Approved by: - Date: -

| | |
|-------------|----------|
| Drawing No. | Revision |
| P1481-002 | 00 |

Drawing Scale: AS NOTED @ A3