



COMHAIRLE NAN EILEAN SIAR

The Town and Country Planning Scotland Act 1997 – Section 36(1)

Town and Country Planning General Development Procedure Order 2013 Regulation 16

Planning Register - Part 1

Application Details

Reference Number	23/00479/PPD
Date registered as valid	16/11/2023
Description of Development	Excavations to accommodate composting tanks and soakaways, installation of 2 no. toilets with access ramps.

Address or description of location to which the development relates	Toilet Block, Butt of Lewis, Ness, Isle of Lewis
---	--

Applicant Name	Urras Oighreachd Ghabhsainn
----------------	-----------------------------

Applicant Address	Business Centre, Tom na Ba, Galson, Isle of Lewis
-------------------	---

Agent name (if applicable)

Agent address (if applicable)

The above application summary is accompanied by plans and drawings sufficient to describe the development and where relevant any design statement.

Important Note: on Tuesday 07 November 2023, Comhairle nan Eilean Siar experienced a criminal cyber incident and is working with Police Scotland, the Scottish Government and the National CyberSecurity Centre to investigate the matter.

The Online Planning Portal remains unavailable as does our suite of integrated software and hardware systems. In order to enable access by the wider public to application documents and consult upon planning applications, interim systems have been put in place on the temporary website of Comhairle nan Eilean Siar, including a rudimentary facility to display a limited number of documents per application.

Any party wishing to view the application file in full may do so at the offices of Comhairle nan Eilean Siar at Sandwick Road, Stornoway Isle of Lewis, HS1 2BW or Balivanich, Isle of Benbecula. HS7 5LA, ordinarily between 9am and 5pm Monday to Friday (excluding public and local holidays). It is recommended that in advance of visiting an office to view an application that you make an appointment by sending an email to planning@cne-siar.gov.uk

2, EOROPIE, NESS, NA H-EILEANAN AN IAR, HS2 0XH

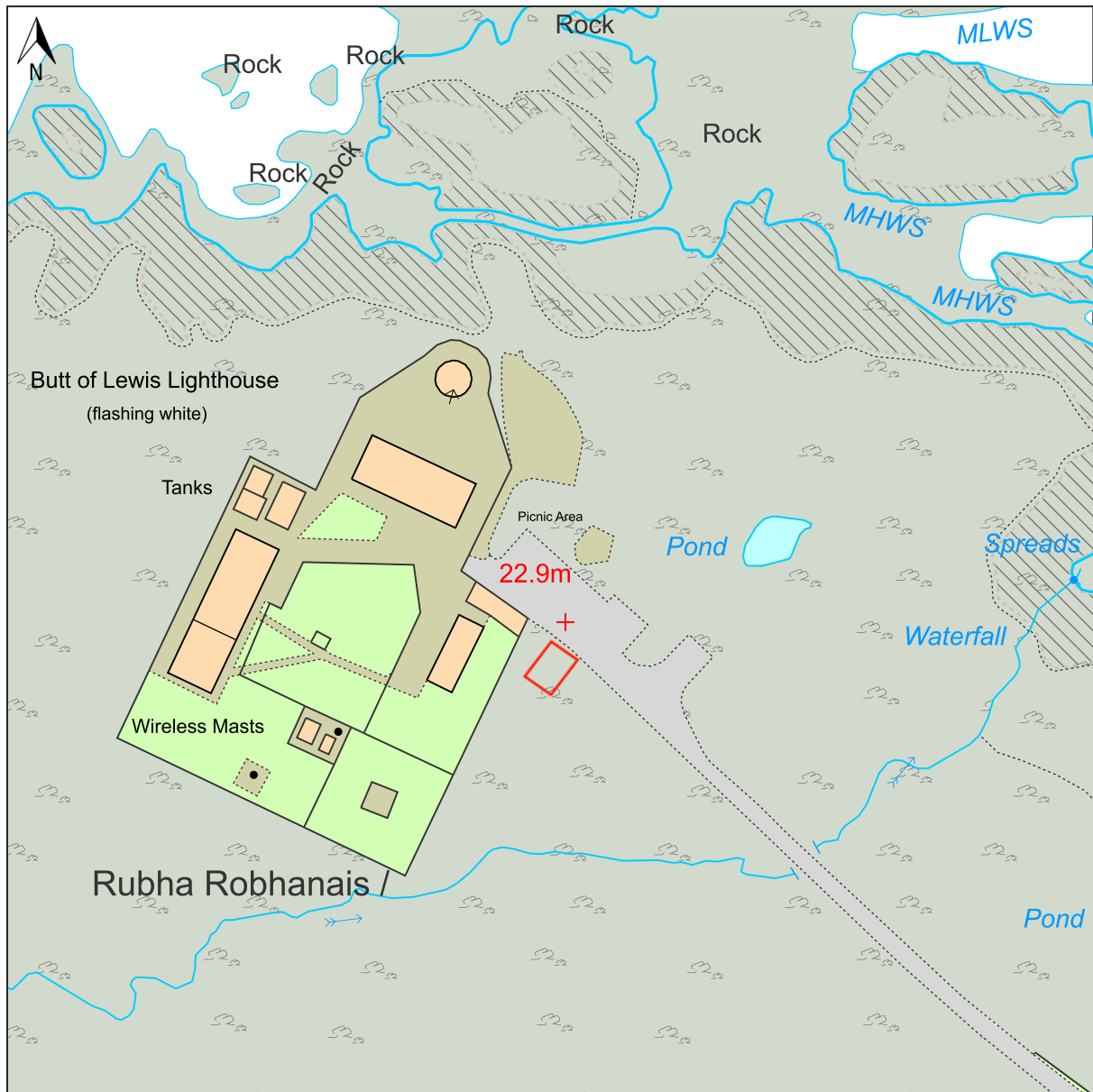

© Crown copyright and database rights, 2023. Ordnance Survey
0100031673 Created using Plans by Emapsite



Scale: 1:1250

Paper Size: A4

Notes:



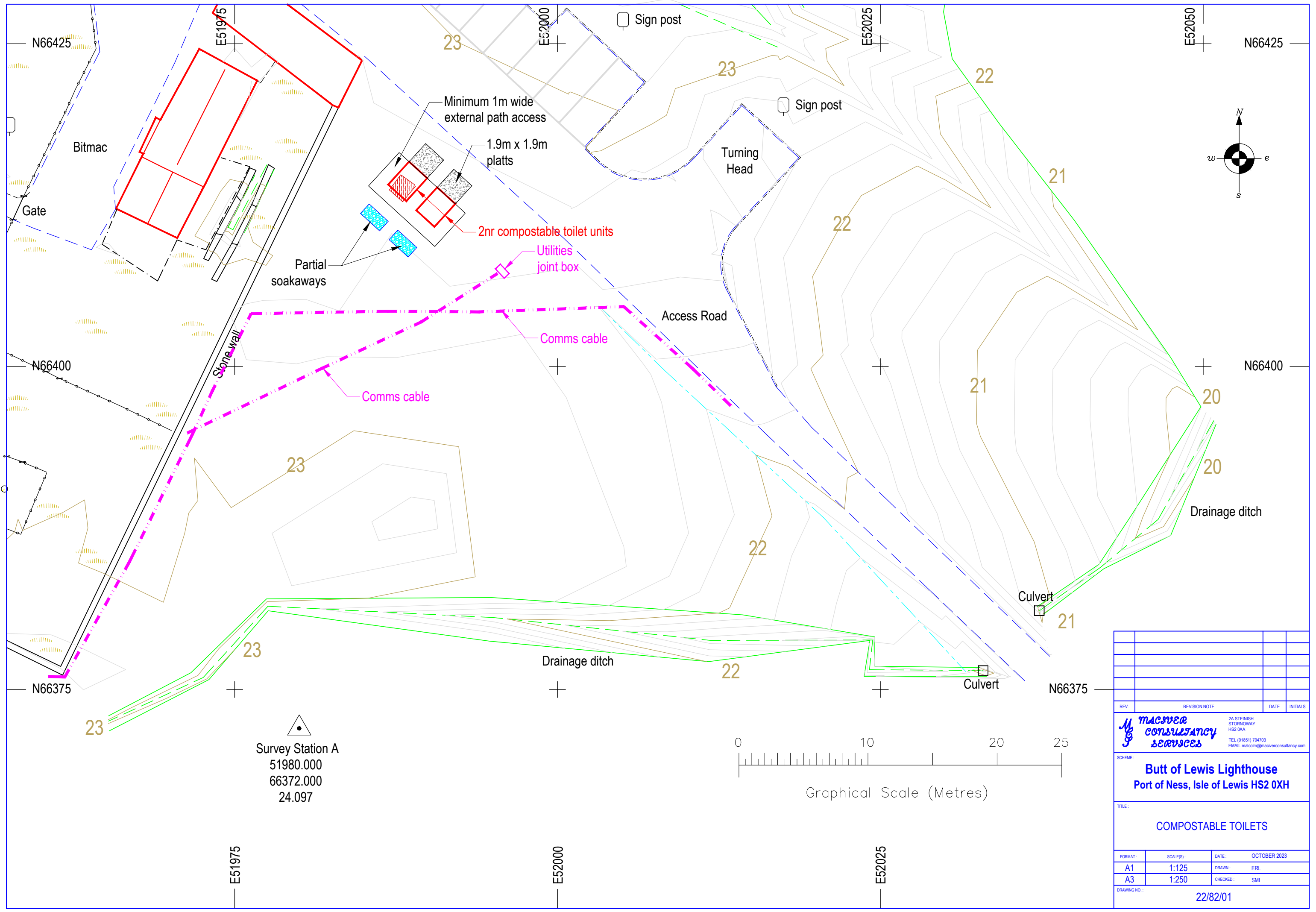

Survey Station A
 51980.000
 66372.000
 24.097



REV.	REVISION NOTE	DATE	INITIALS

MACIVER CONSULTANCY SERVICES
 2A STERNSH STORNOWAY HS2 0AA
 TEL: (01851) 704703
 EMAIL: maciv@maciverconsultancy.com

SCHEME:
Butt of Lewis Lighthouse
Port of Ness, Isle of Lewis HS2 0XH

TITLE:
COMPOSTABLE TOILETS

FORMAT:	SCALE(S):	DATE:	
A1	1:125	DRAWN:	ERL
A3	1:250	CHECKED:	SMI

DRAWING NO.: **22/82/01**

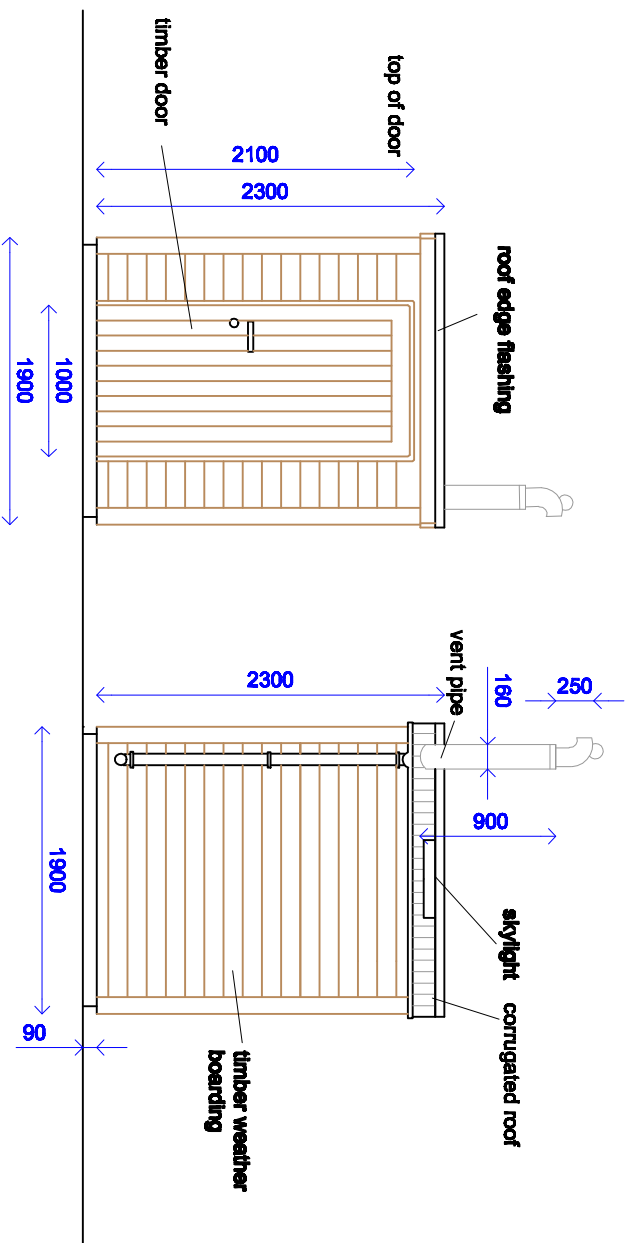

NOT TO BE USED FOR CONSTRUCTION PURPOSES

 <p>THE COMPOST TOILET SPECIALISTS</p>		<p>Compus Twin - Full Access front and rear</p>	
		<p>Date 03.9.10 Scale 1:50</p>	
<p>Natsol Ltd Tel: 01896 412863 www.natsol.co.uk</p>		<p>Dwg. No.</p>	
		<p>Dm. B.Wade</p>	

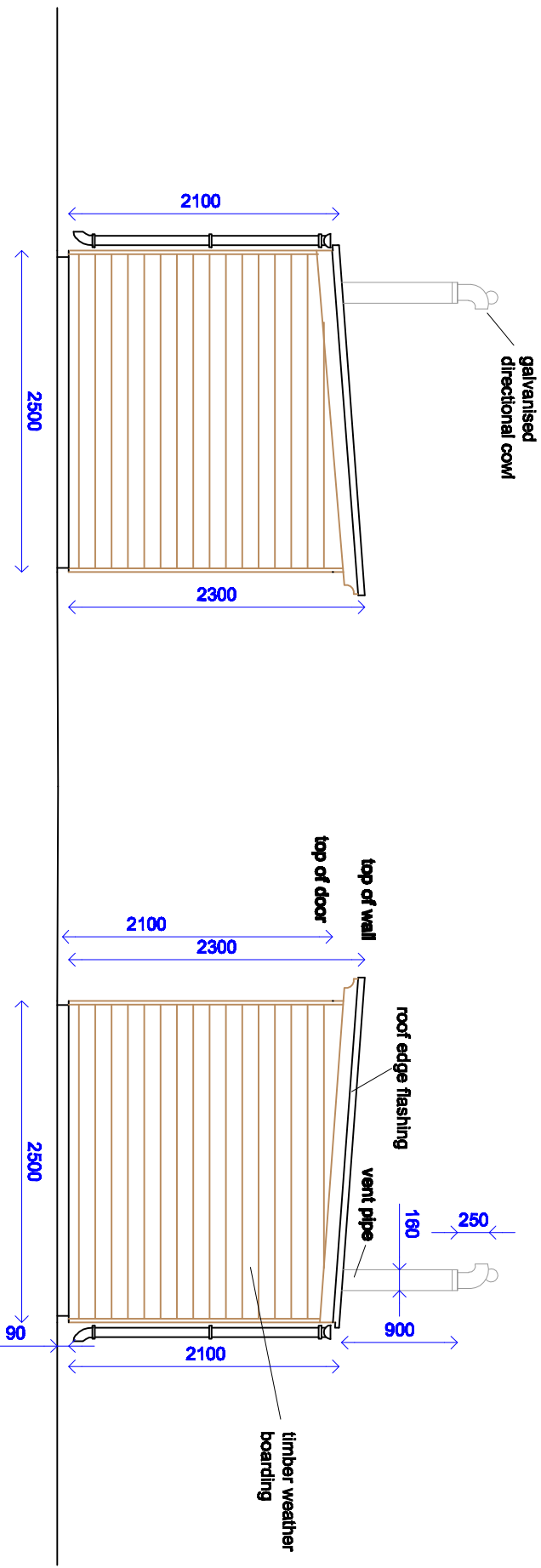

NOT TO BE USED FOR CONSTRUCTION PURPOSES

 <p>THE COMPOST TOILET SPECIALISTS</p>		<p>Natsol Ltd Tel: 01696 412653 www.natsol.co.uk</p>	
		<p>Compus Twin - Full Access side elevation</p>	<p>Date 09.4.08 Scale 1:50</p>
<p>Dwg. No.</p>		<p>Drn. B. Wade</p>	

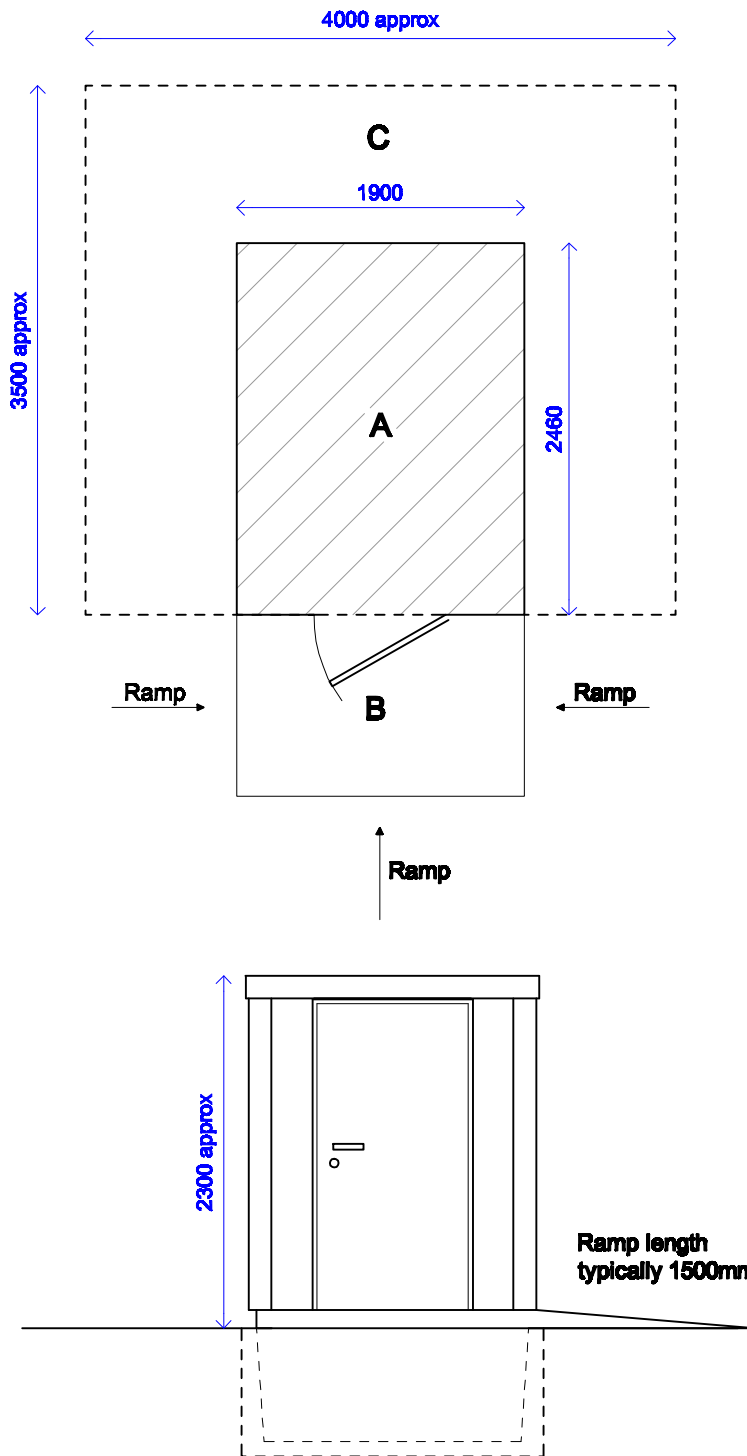

KEY

Hatched area 'A' is building footprint and excavation area. Excavations approx 2m x 2.5m x 850mm deep. DO NOT PREPARE IN ADVANCE.

'B' is level area in front of door about 120mm above surrounding ground level and a minimum 1200mm width.

'C' is clear space of approximately 1m wide all round for erection and maintenance.

NOTES

1. Door opens out.
2. Ramp from any direction at maximum slope of 1:12

 <p>NatSol THE COMPOST TOILET SPECIALISTS</p>	Full Access Compus Twin	
	Site Dimensions	
Date 8.8.06	Scale 1:50	
Drg. No.		
Drn. B.Wade		
Natsol Ltd Tel: 01686 412653 www.natsol.co.uk		

OPTION A

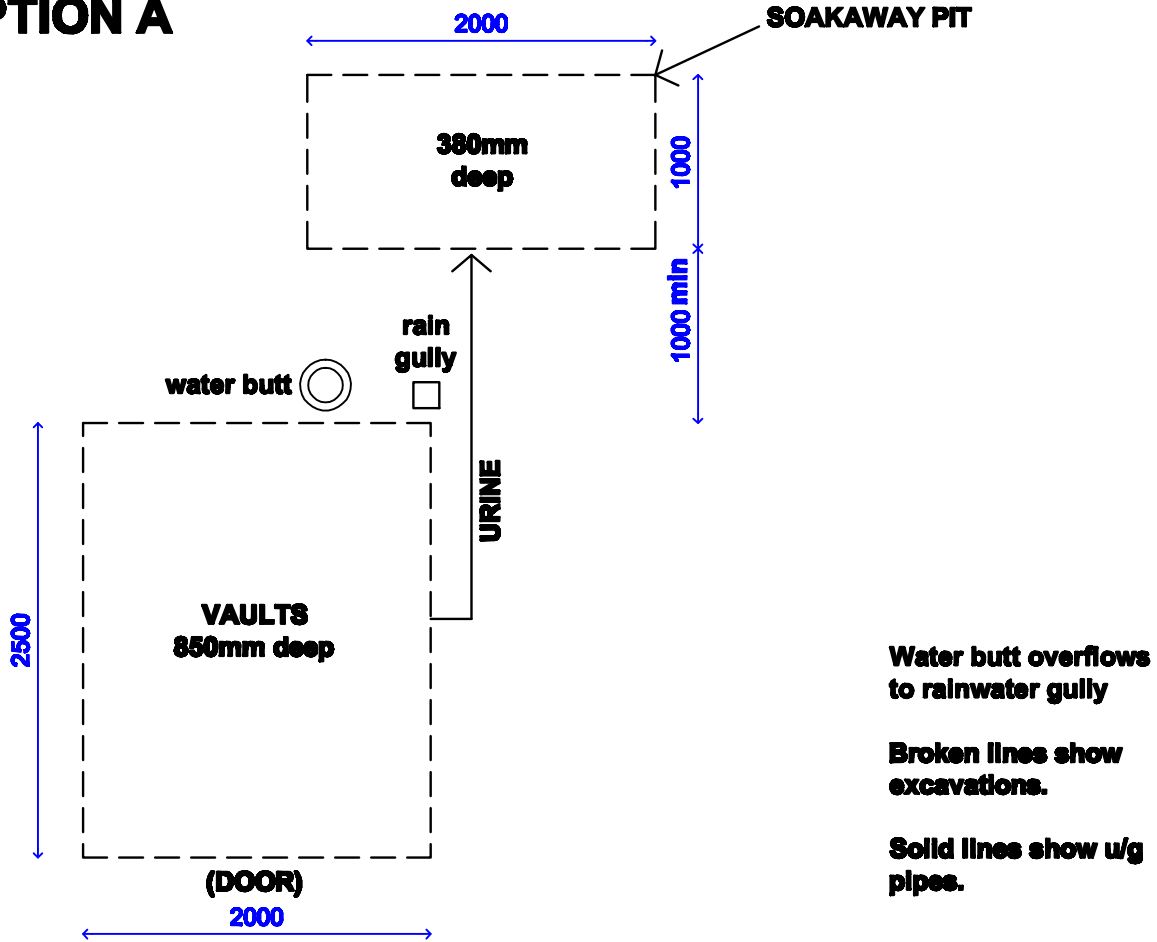

OPTION B

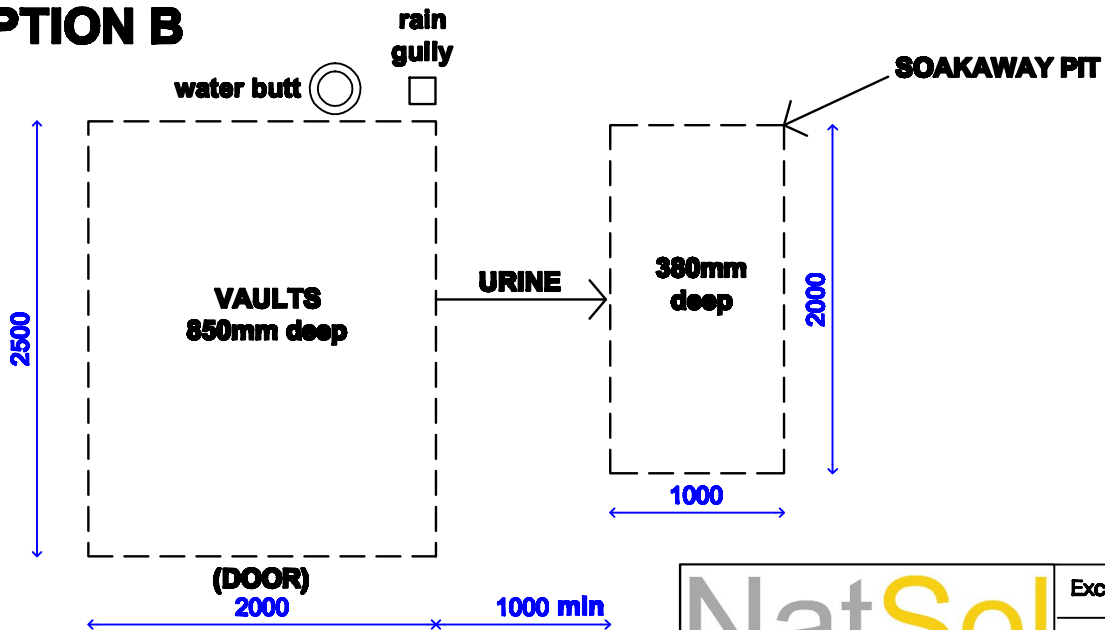

NatSol THE COMPOST TOILET SPECIALISTS	Excavations	
	Options A and B	
Natsol Ltd Tel: 01686 412653 www.natsol.co.uk	Date 01.2.10	Scaled to fit
	Drg. No.	
	Dm. B.Wade	

SOAKAWAYS AND FLOODING RISK – SLOPING SITES

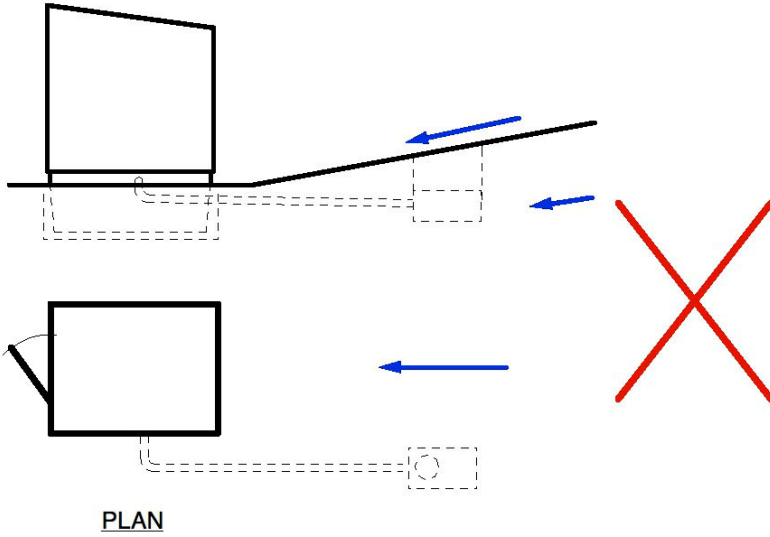

Ground water around the soakaway could cause vaults to flood!!

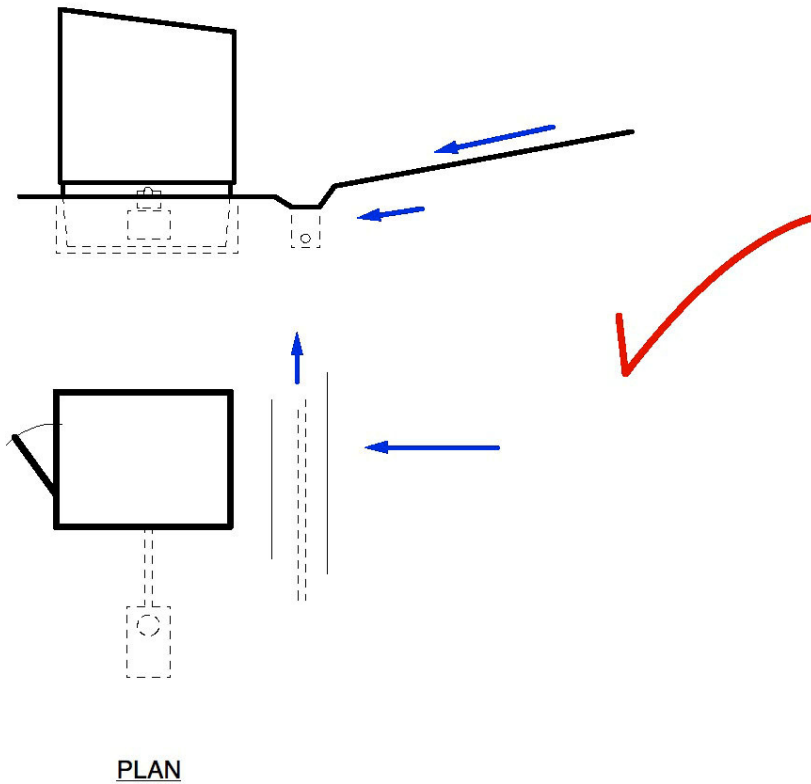

Install a land-drain to prevent flooding of soakaway area.