



COMHAIRLE NAN EILEAN SIAR

The Town and Country Planning Scotland Act 1997 – Section 36(1)

Town and Country Planning General Development Procedure Order 2013 Regulation 16

Planning Register - Part 1

Application Details

Reference Number:	23/00382/PPD
Date registered as valid:	01 November 2023
Description of Development:	Erect Agricultural Shed
Address or description of location to which the development relates:	34 Muir of Aird
Applicant Name	Mr James Alasdair Ellwood
Applicant Address	Strome, Baymore, Grimsay, HS6 5HX
Agent name (if applicable)	
Agent address (if applicable)	

The above application summary is accompanied by plans and drawings sufficient to describe the development and where relevant any design statement.

Important Note: on Tuesday 07 November 2023, Comhairle nan Eilean Siar experienced a criminal cyber incident and is working with Police Scotland, the Scottish Government and the National Cyber Security Centre to investigate the matter.

The Online Planning Portal remains unavailable as does our suite of integrated software and hardware systems. In order to enable access by the wider public to application documents and consult upon planning applications, interim systems have been put in place on the temporary website of Comhairle nan Eilean Siar, including a rudimentary facility to display a limited number of documents per application.

Any party wishing to view the application file in full may do so at the offices of Comhairle nan Eilean Siar at Sandwick Road, Stornoway Isle of Lewis, HS1 2BW or Balivanich, Isle of Benbecula. HS7 5LA, ordinarily between 9am and 5pm Monday to Friday (excluding public and local holidays). It is recommended that in advance of visiting an office to view an application that you make an appointment by sending an email to planning@cne-siar.gov.uk

Location Plan for 34 Aird, Benbecula HS7

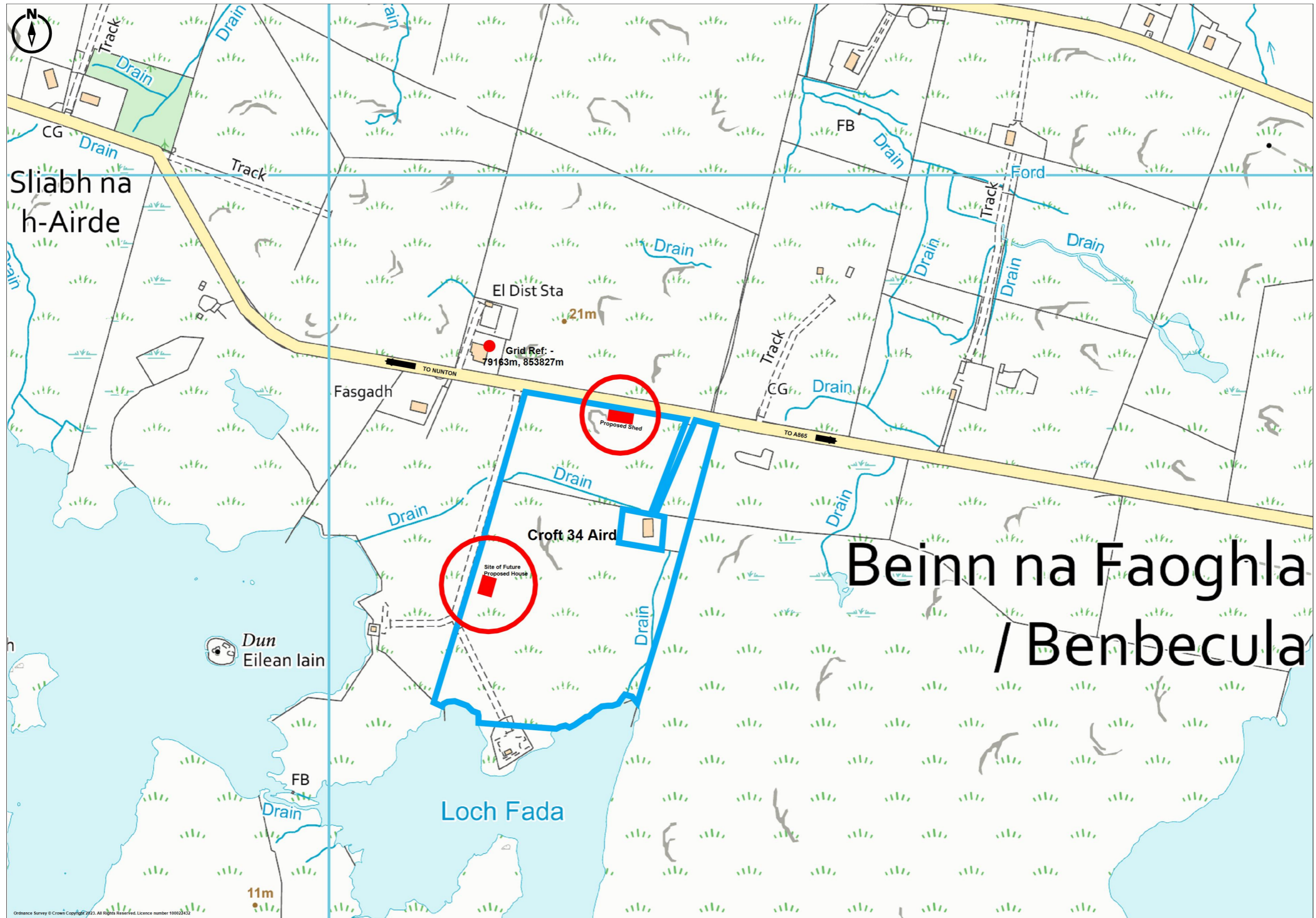

Site Plan for Proposed Agricultural Shed and New Access at 34 Aird, Benbecula, HS7

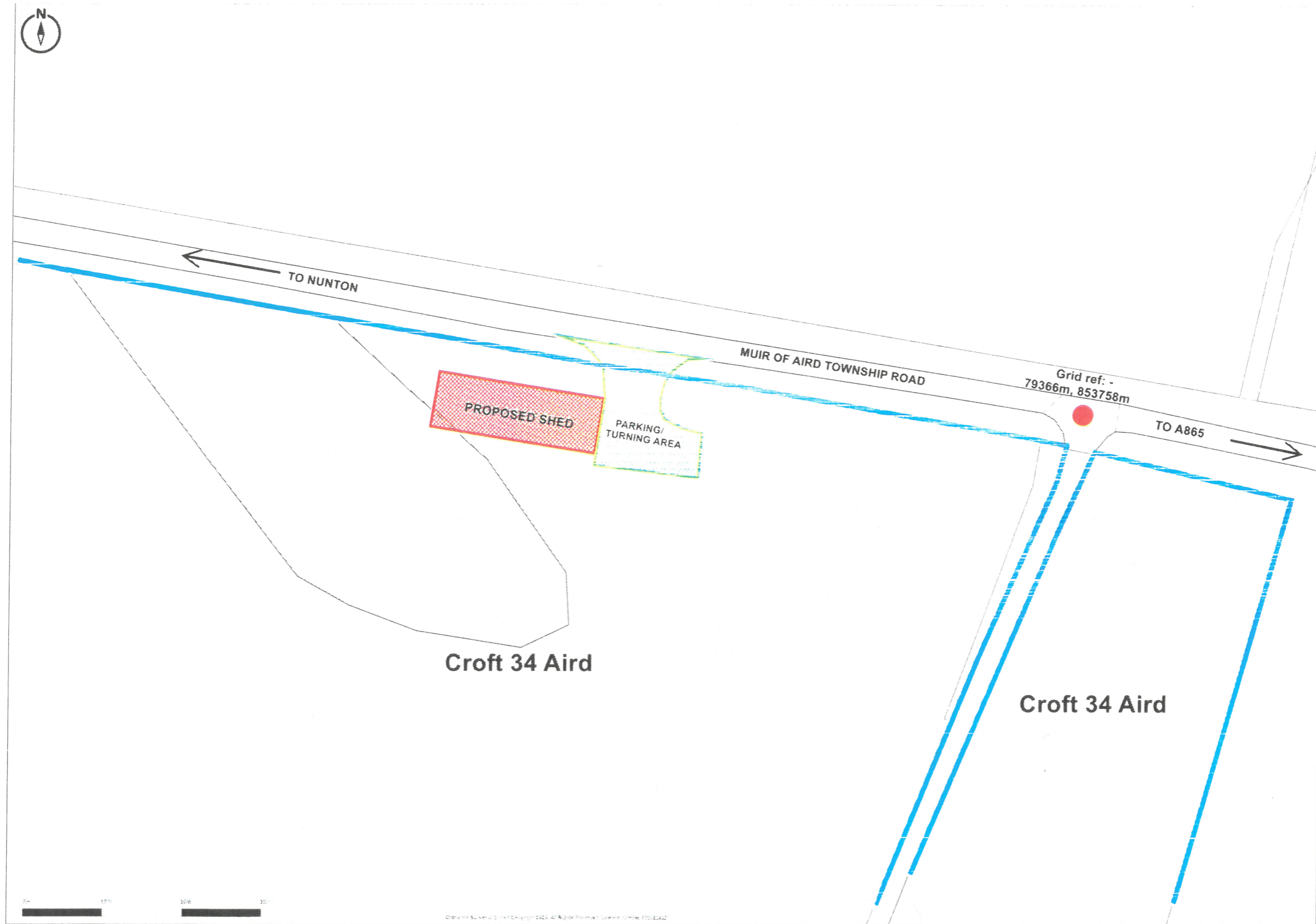

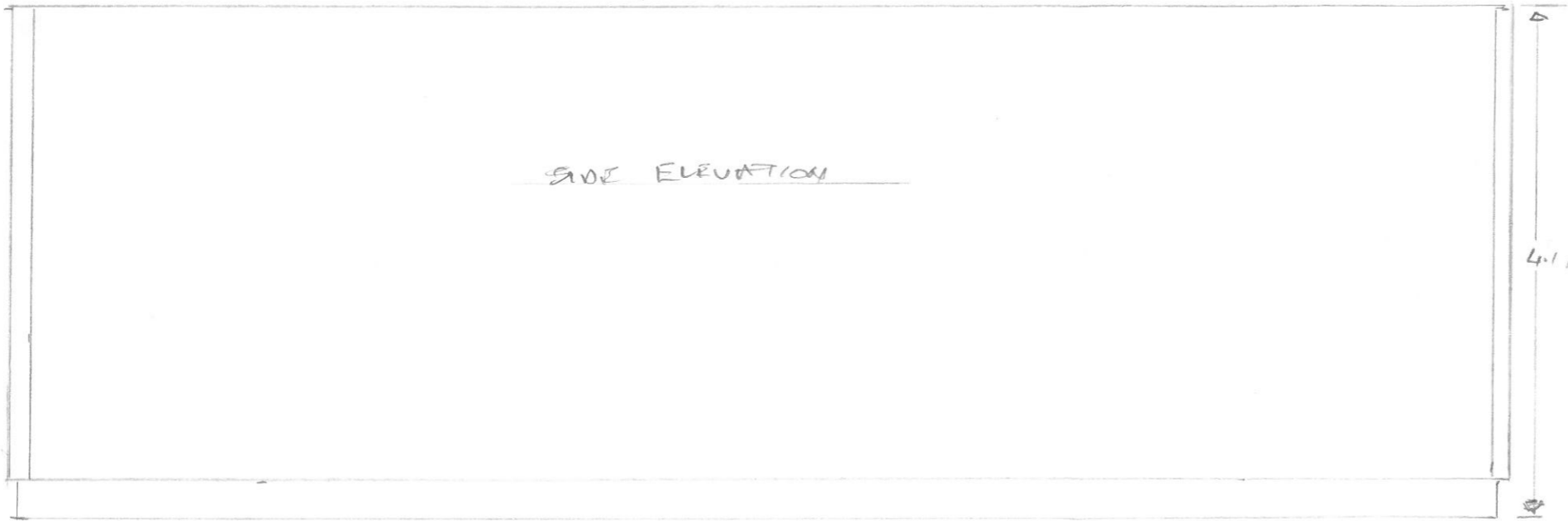

SIDE ELEVATION

4.1 mts

Beams ON FLAT 200

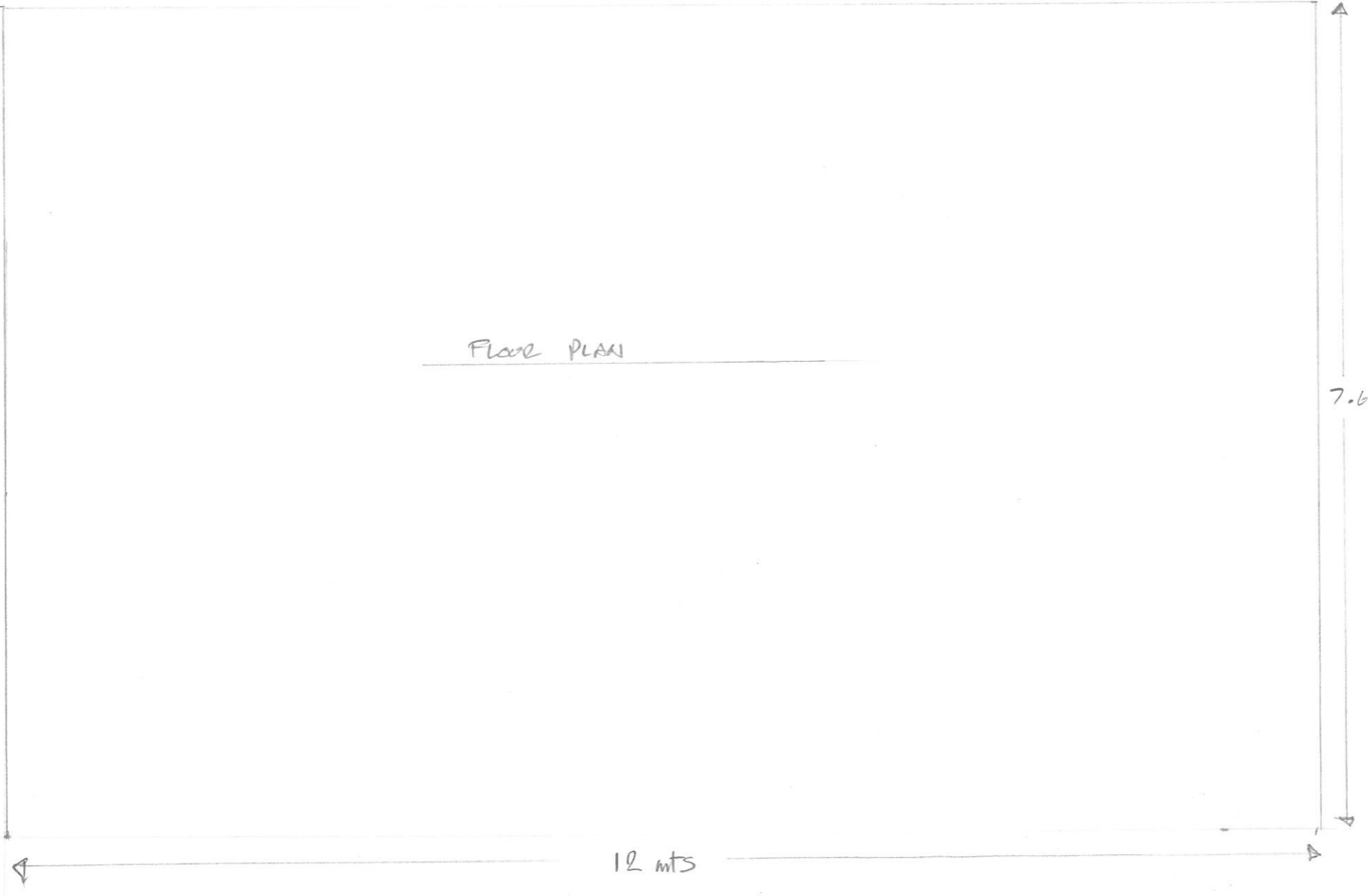

Floor PLAN

7.65 mts

12 mts

SCALE 1:50

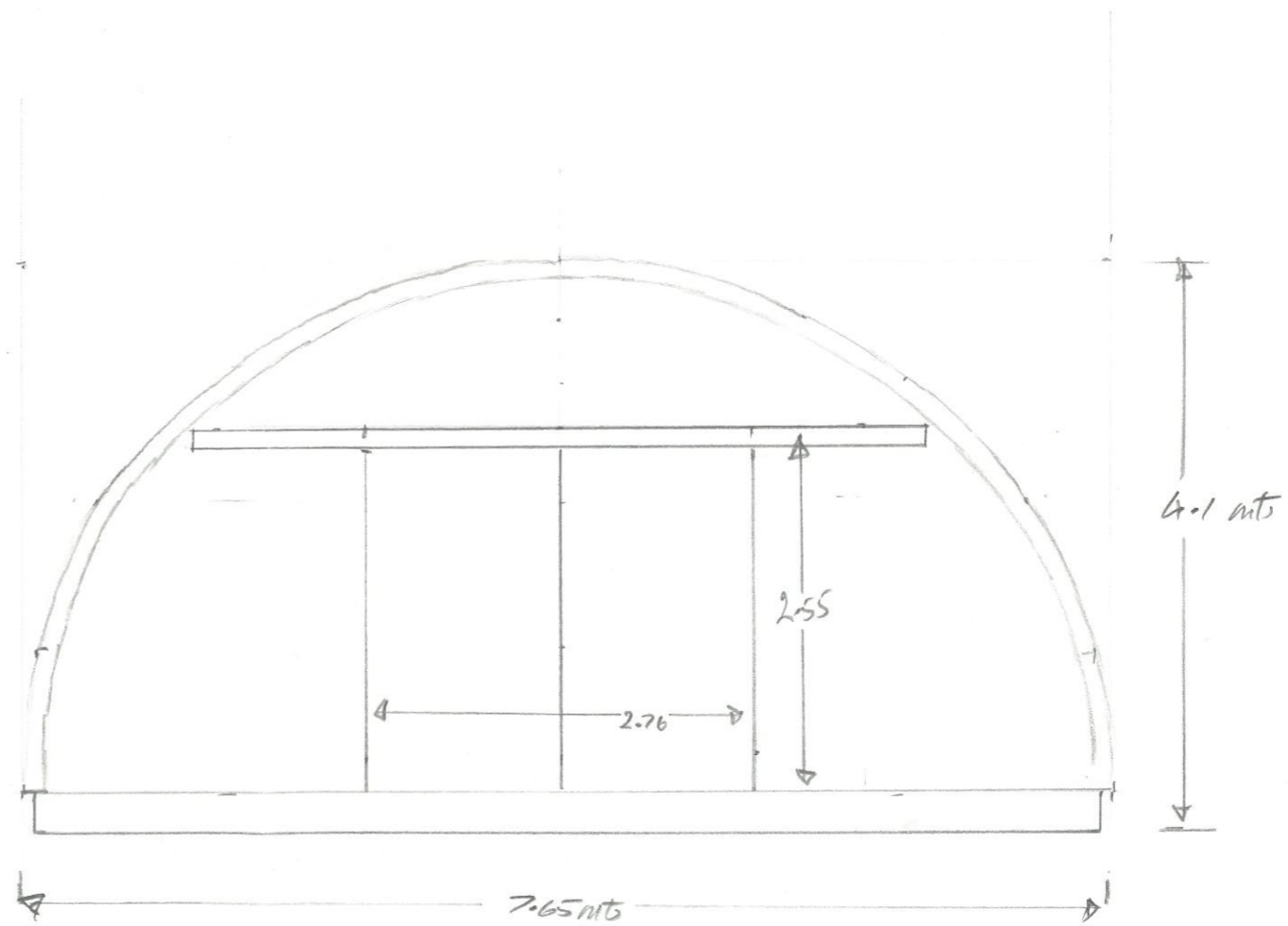

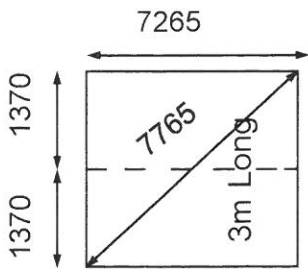

Overall Slab 2950 x 7525mm

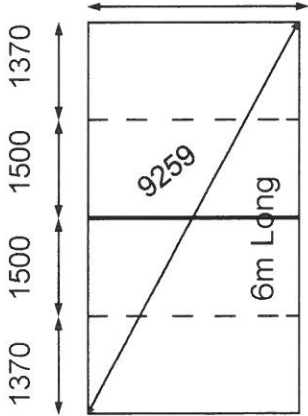

Overall Slab 5950 x 7525mm

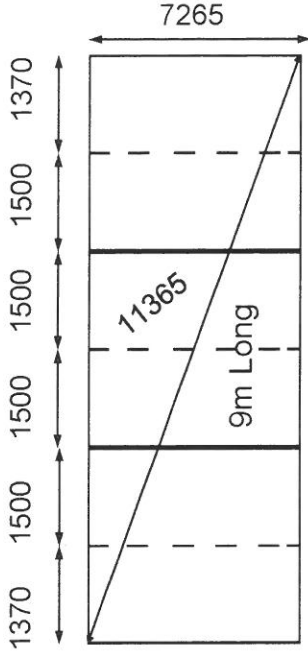

Overall Slab 8950 x 7525mm

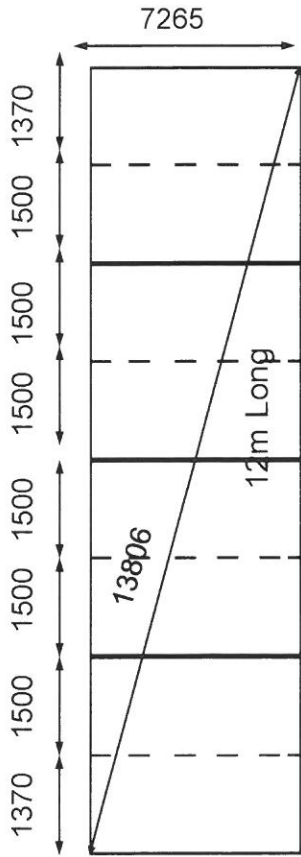

Overall Slab 11950 x 7525mm

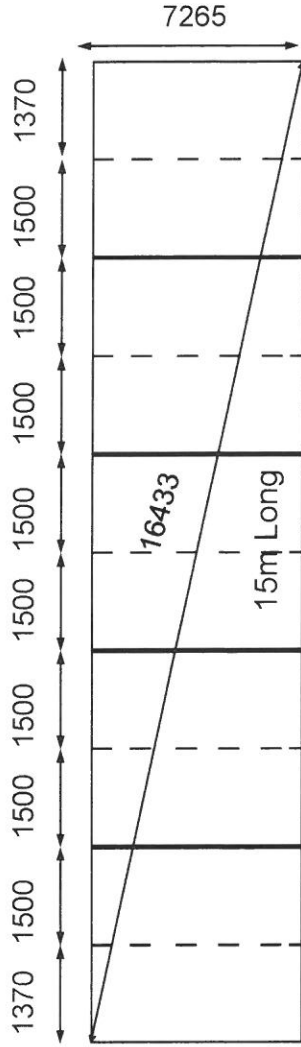

Overall Slab 14950 x 7525mm

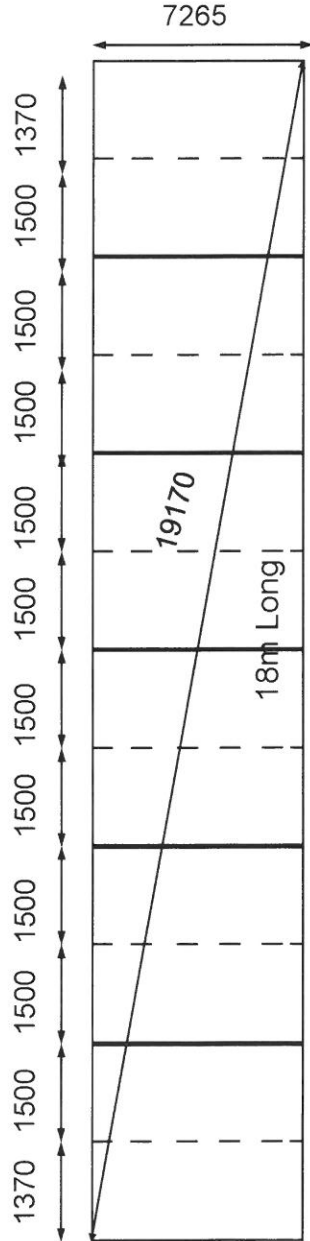

Overall Slab 17950 x 7525mm

ALL DIMENSIONS ARE TO BOLT CENTRES IN MILLIMETRES

Diagonals for 1500 bays 7418mm

Diagonals for 1370 bays 7393mm

Job: 24FT (7.31M) NISSEN SHED	Client	Gareth Pugh Steel Framed Buildings Abermule, Powys, SY15 6NH Tel. 016886 630500 © July 2018
Drawing: HOLDING DOWN BOLT CENTRES	FOR CUSTOMER USE	
Drawing No: N24/1/1.5		