

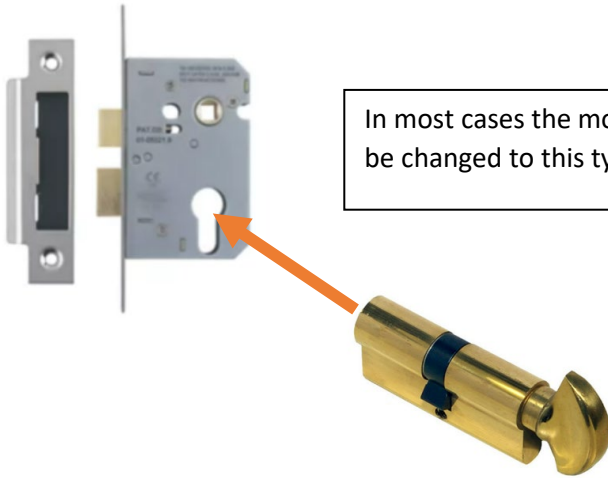

If the door handle looks like this and has a key like this....



Within the door, the mortice lock will look like this



In most cases the mortice lock can be changed to this type



A new handle will also require to be fitted.



If you have this type of handle & lock (on the inside of the door), then watch the following video: -

[How to change a euro lock cylinder - YouTube](#)



[How to change a euro lock cylinder](#)

YouTube · B&Q
3 Dec 2013

If it is not possible to change the lock then an alternative could be a night latch (see below)



If you do fit a night latch then the key from the original lock should be covered on the inside of the door to prevent the door being locked with the key from the inside.



This hole should be covered on the inside of the door, one method would be to take the handle off and fit plastic/metal at rear and re-fit the handle. Please add this to the Fire Risk Assessment stating the lock has been disabled on the inside of the door.